

ADDENDUM NO. 1

TO: ALL PLAN HOLDERS

RE: Water Distribution Improvements: McGehee Water and Sewer Commission
McGehee, Arkansas MCG-03-26

ADDENDUM DATE: March 20, 2026

The Plans, Specifications and Contract Documents for the above-referenced project are hereby modified as follows:

- 1. Updated Plan Sheets:**
Please see attached documents.
- 2. Updated Bid Proposal:**
Please see attached documents.
- 3. Bid Opening Date has been changed to Thursday, March 26, 2026 at 2:15pm. Opening will still be at 901 Holly Street, McGehee, Arkansas 71654.**

ADDENDUM NO. 1 ISSUED BY:

A.L. FRANKS ENGINEERING

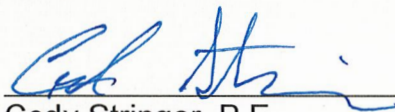
Cody Stringer, P.E.

Project Engineer/Vice President-El Dorado Operations

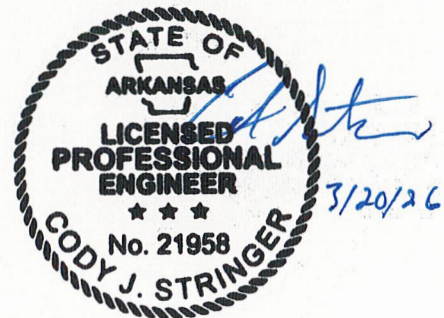

CITY OF MCGEHEE, ARKANSAS
WATER DISTRIBUTION IMPROVEMENTS
BID DATE: MARCH 26, 2026

BID PROPOSAL

ITEM	QTY	UNIT	DESCRIPTION	UNIT PRICE
1	2,040	L.F.	Furnish and Install labor and equipment for 6" C-900 PVC Water Main and Fittings including Trench Excavation, Laying, Bedding, Blocking and Backfilling per plans and specifications for the unit price of _____	

2	1,880	L.F.	Furnish and Install labor and equipment for 6" C-900 PVC Water Main and Fittings including Trench Excavation, Laying, Bedding, Blocking and Backfilling per plans and specifications for the unit price of _____	

			_____ Dollars and Cents/LF	
			_____	\$ _____
			_____	\$ _____

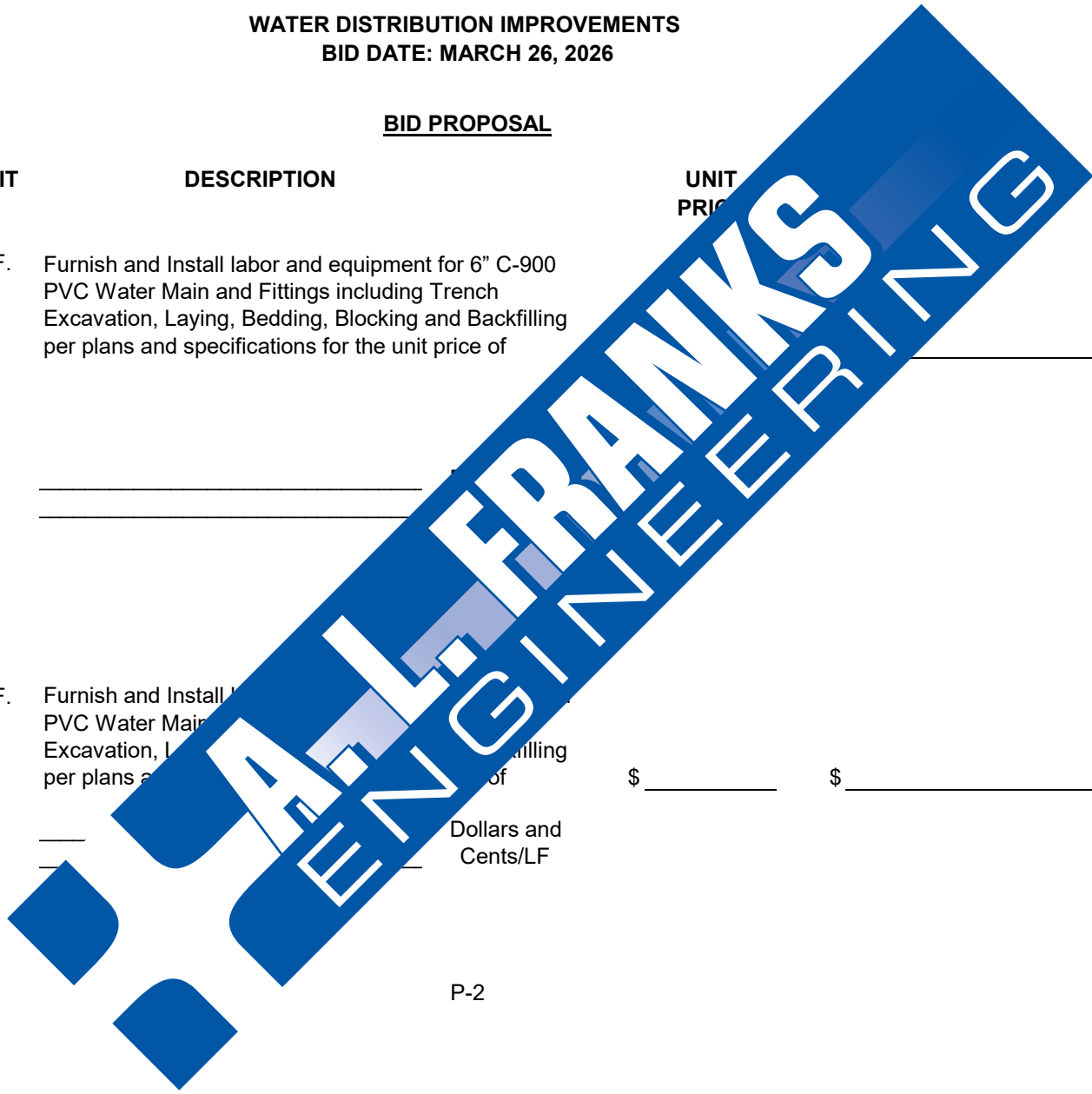

BID PROPOSAL CONTINUED

ITEM	QTY	UNIT	DESCRIPTION	UNIT PRICE	TOTAL PRICE
3	220	L.F.	Furnish and Install material, labor and equipment for 2" poly water pipe SDR-9 treated water main and Fittings including Trench Excavation, Laying, Bedding, Blocking and Backfilling per plans and specifications for the unit price of	\$ _____	_____
			_____ Dollars and _____ Cents/LF		

4	540	L.F.	Directional Bore 6" Certa-Loc _____ per plans and specifications (Directional Bore include _____)	\$ _____	\$ _____
			_____ s and _____ ents/LF		

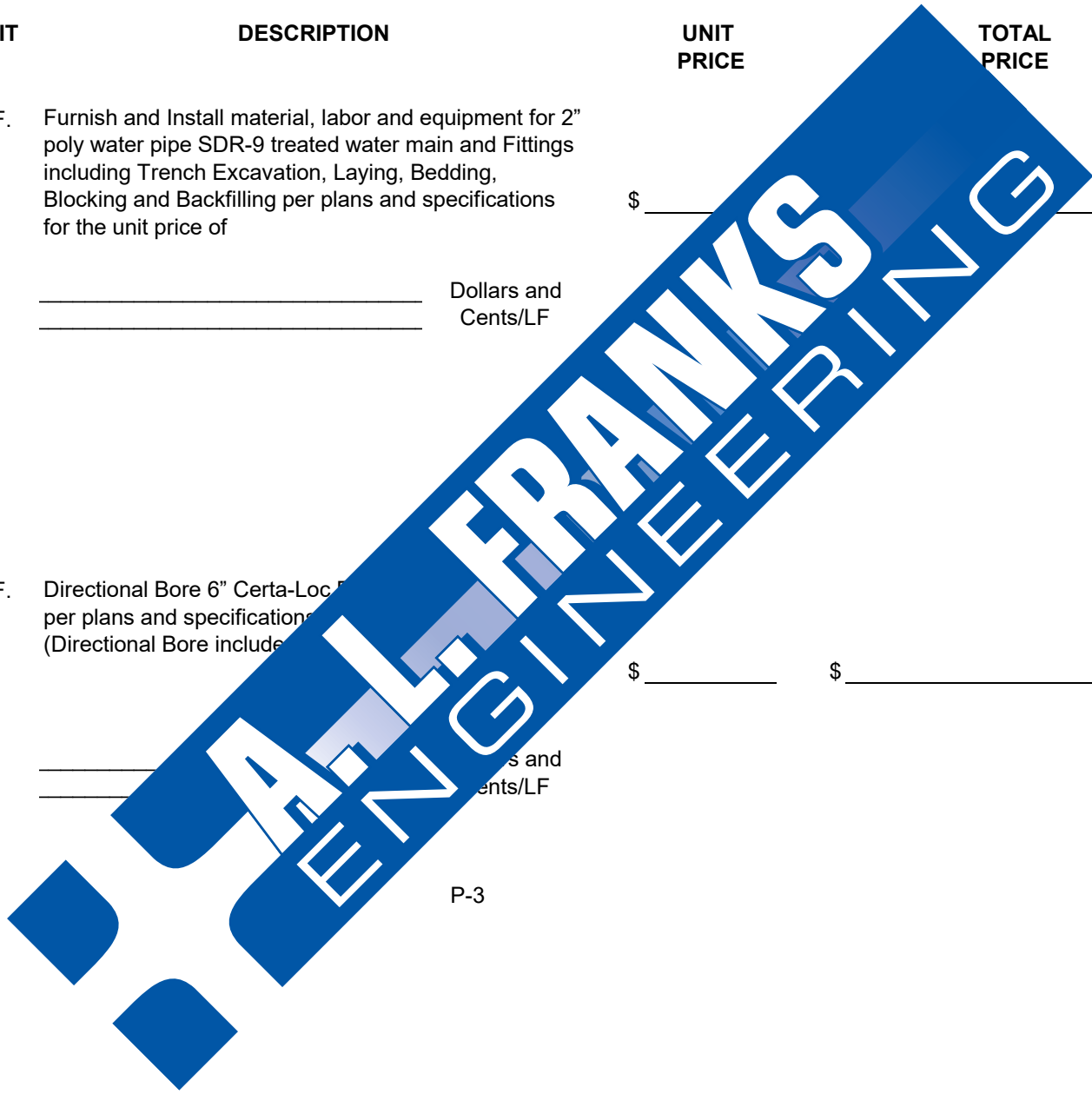

BID PROPOSAL CONTINUED

ITEM	QTY	UNIT	DESCRIPTION	UNIT PRICE	TOTAL PRICE
5	1520	L.F.	Directional Bore 3" Certa-Loc Pipe SDR-17 Water main per plans and specifications for the unit price of (Directional Bore includes the pipe)	\$ _____	_____
			_____ Dollars and Cents/L.F		

6	30	L.F.	Directional Bore 2" Certa-Loc Pipe SDR-17 Water main per plans and specifications for the unit price of (Directional Bore includes the pipe)	\$ _____	\$ _____
			_____ and Cents/L.F		

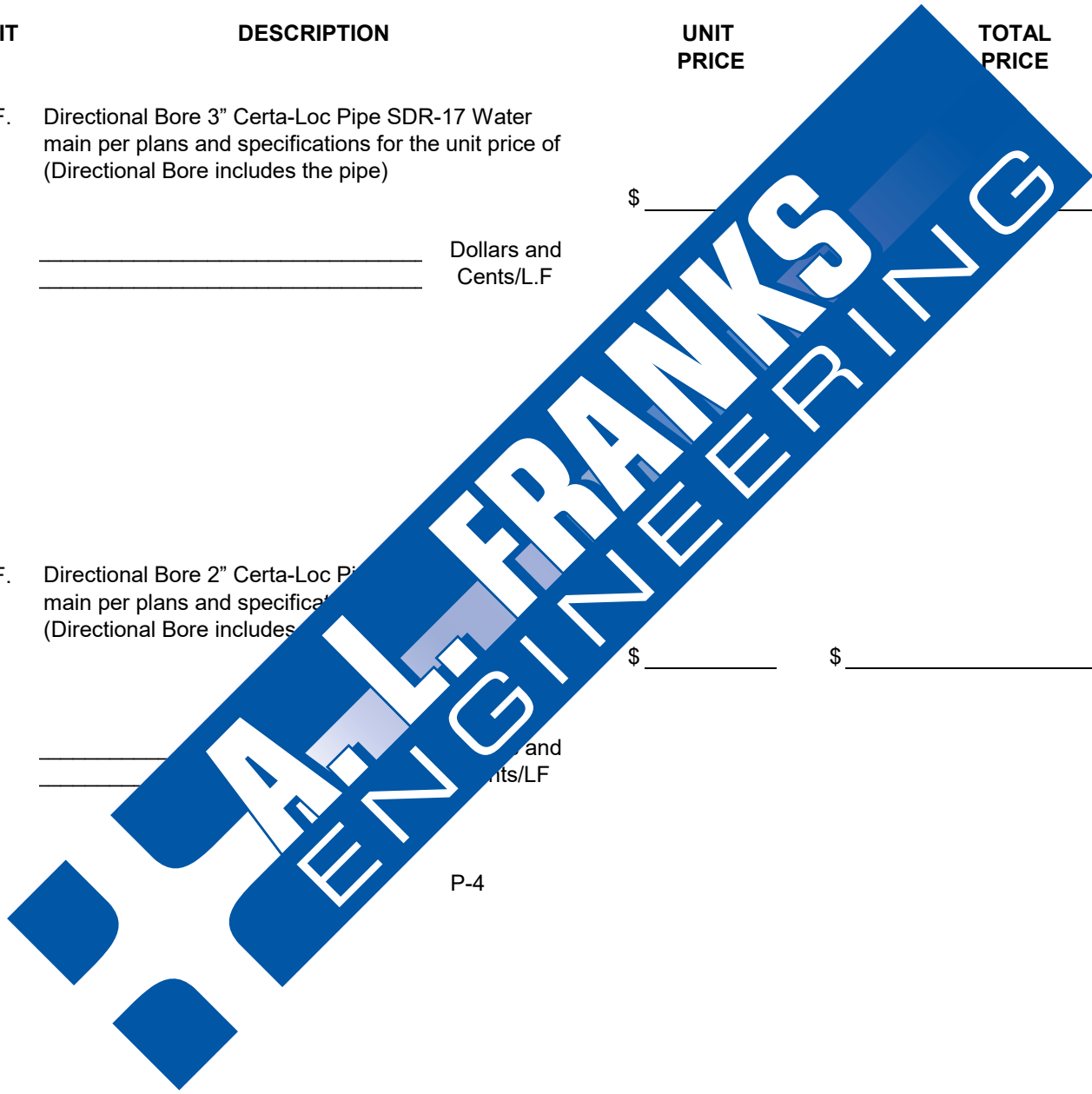

BID PROPOSAL CONTINUED

ITEM	QTY	UNIT	DESCRIPTION	UNIT PRICE	TOTAL PRICE
7	4	EA.	Tie in Existing 6" Water Line per plans and specifications for the unit price of (Does not include valve) (Not a Pay Item if Tapping Sleeve or Saddle is used)	\$ _____	_____
			_____ Dollars and _____ Cents/EA		

8	2	EA.	Furnish and Install 8"X3" M.I. Valve including valve box specifications for the u	\$ _____	\$ _____
			_____ and _____ s/EA		

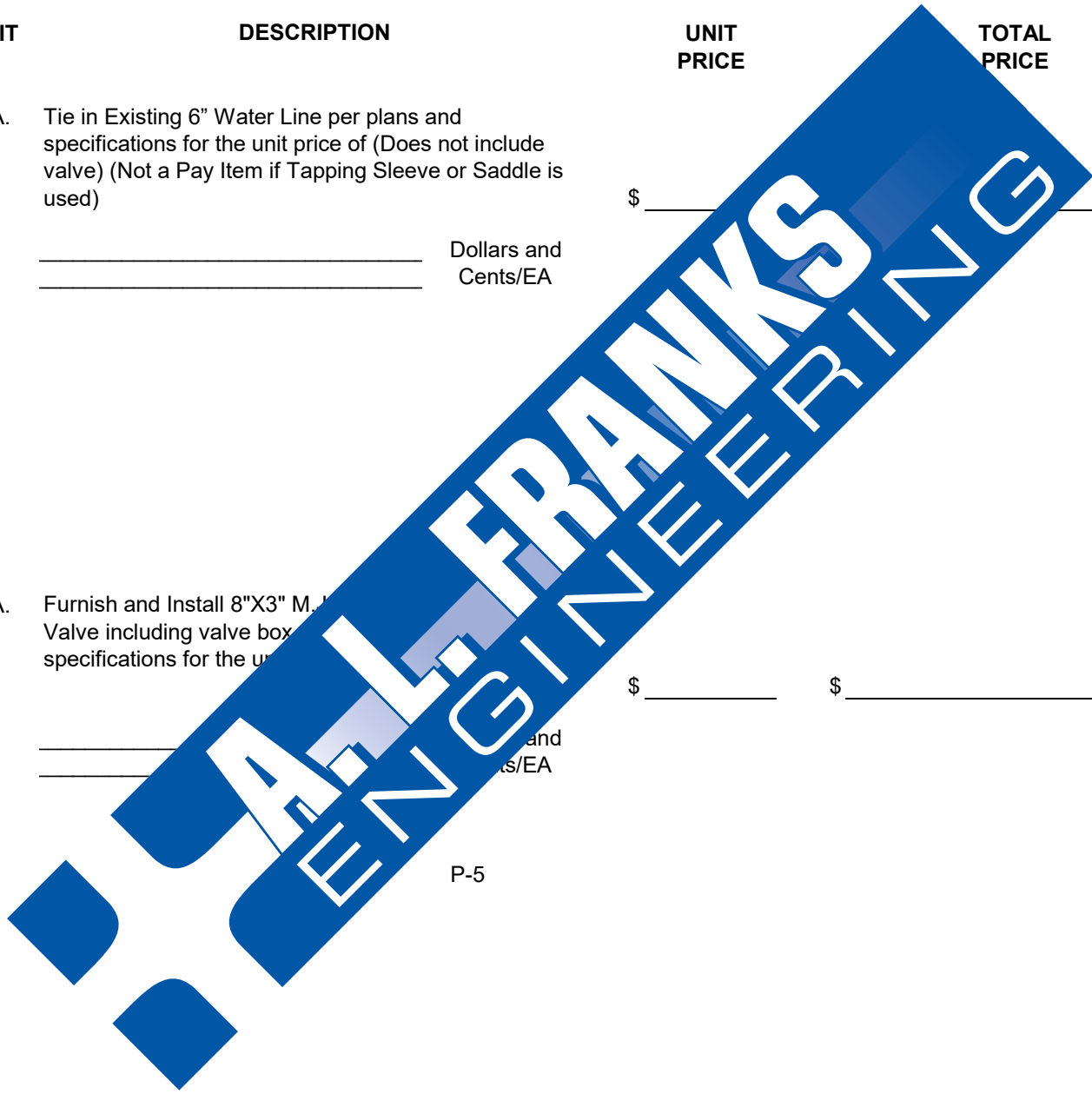

BID PROPOSAL CONTINUED

ITEM	QTY	UNIT	DESCRIPTION	UNIT PRICE	TOTAL PRICE
9	3	EA.	Furnish and Install 6"X6" M.J. Tapping Sleeve and Valve including valve box and blocking per plans and specifications for the unit price of	\$ _____	_____
			_____ Dollars and		
			_____ Cents/EA		
10	4	EA.	Furnish and Install 6"X3" M.J. Tapping Sleeve and Valve including valve box and blocking per plans and specifications for the unit price of	\$ _____	\$ _____
			_____ Dollars and		
			_____ Cents/EA		

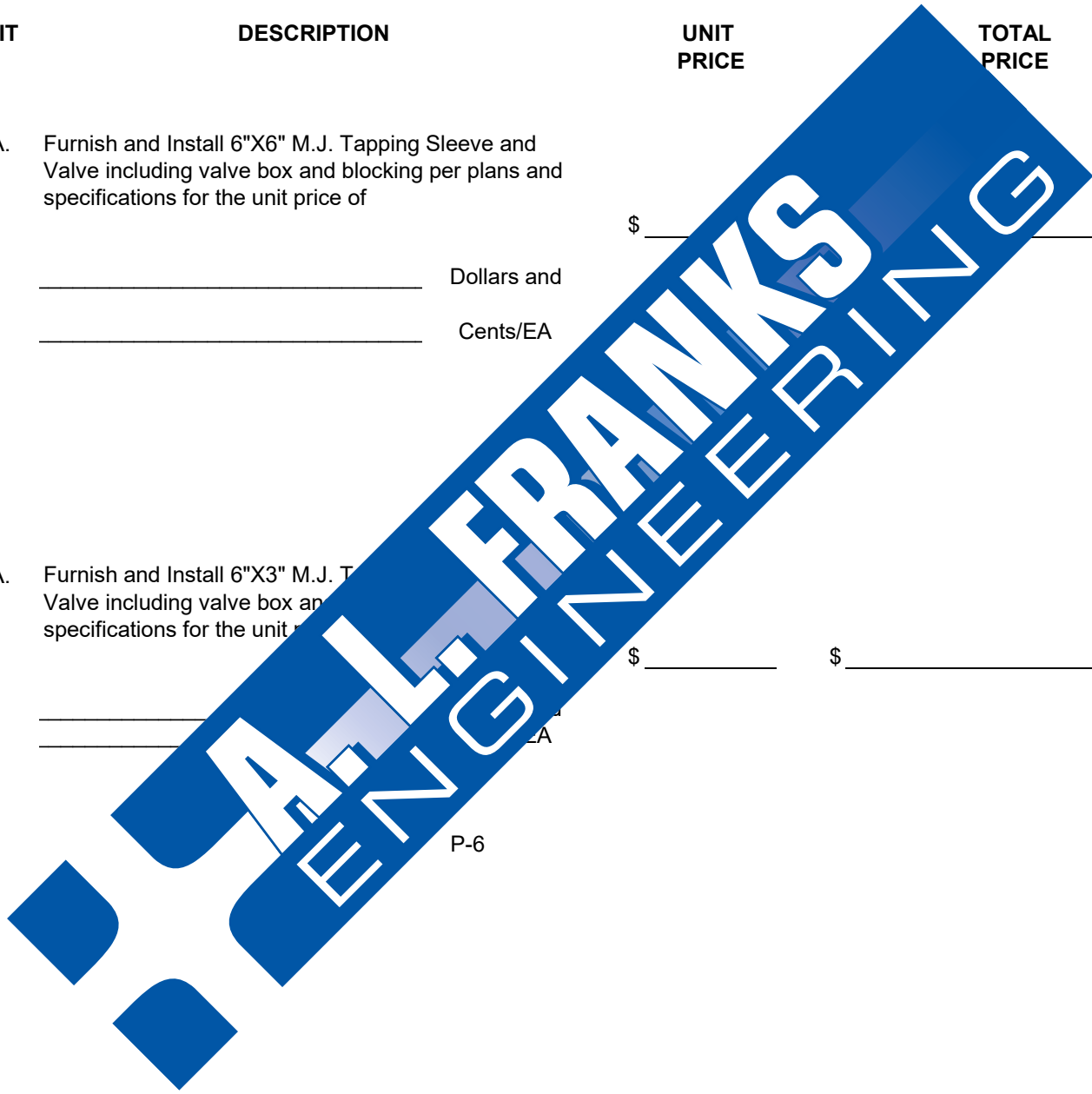

BID PROPOSAL CONTINUED

ITEM	QTY	UNIT	DESCRIPTION	UNIT PRICE	TOTAL PRICE
11	3	EA.	Furnish and Install 4"X3" M.J. Tapping Sleeve and Valve including valve box and blocking per plans and specifications for the unit price of	\$ _____	_____
			_____ Dollars and Cents/EA		
12	10	EA.	Furnish and Install 6" Gate Valve including valve valve marker and blocking per plans and specifications for the unit price of	\$ _____	_____

13	11	EA.	Furnish and Install 4"X3" M.J. Tapping Sleeve and Valve including valve box, valve marker and blocking per plans and specifications for the	\$ _____	\$ _____
			_____ Dollars and Cents/EA		

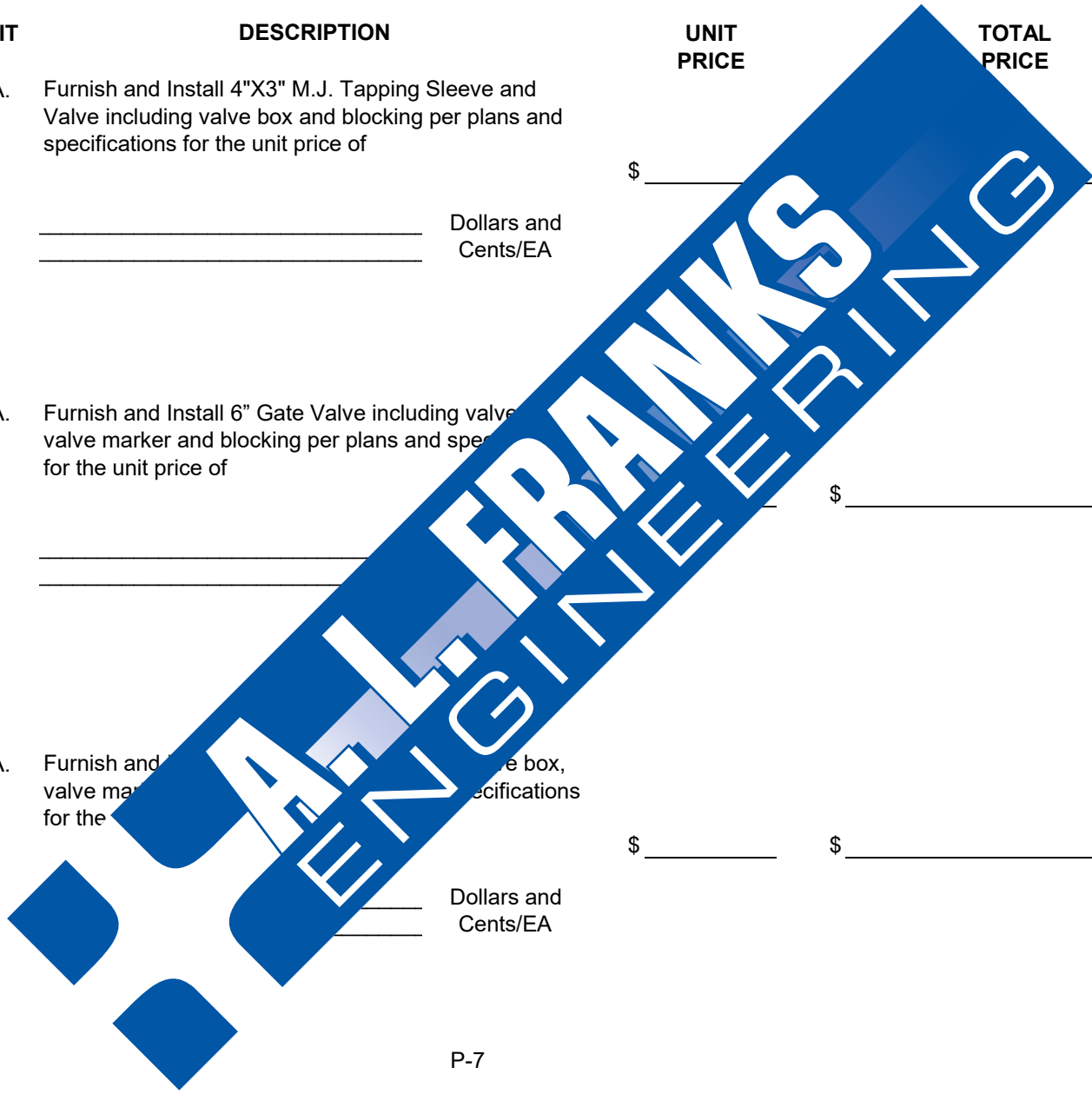

BID PROPOSAL CONTINUED

ITEM	QTY	UNIT	DESCRIPTION	UNIT PRICE	TOTAL PRICE
14	1	EA.	Furnish and Install 2" Gate Valve including valve box, valve marker and blocking per plans and specifications for the unit price of	\$ _____	_____
			_____ Dollars and		
			_____ Cents/EA		
15	5	EA.	Furnish and Install 6" Fire Hydrant Ass. 6" Gate Valve, Blocking and Drain P. specifications for the unit price of	\$ _____	_____

16	5	EA.	Remove ex. _____ the City per plan _____ of _____	\$ _____	\$ _____
			_____ Dollars and		
			_____ Cents/EA		

BID PROPOSAL CONTINUED

ITEM	QTY	UNIT	DESCRIPTION	UNIT PRICE	TOTAL PRICE
17	55	EA	Furnish and Install all 3/4" Short Side Service Connections Including up to 60 feet of service line to existing meters per plans and specification sfor the unit price of	\$ _____	_____
			_____ Dollars and Cents/EA		

18	23	EA.	Furnish and Install and 3/4" Long S Connections Including up to 120 existing meters per plans and price of	\$ _____	\$ _____

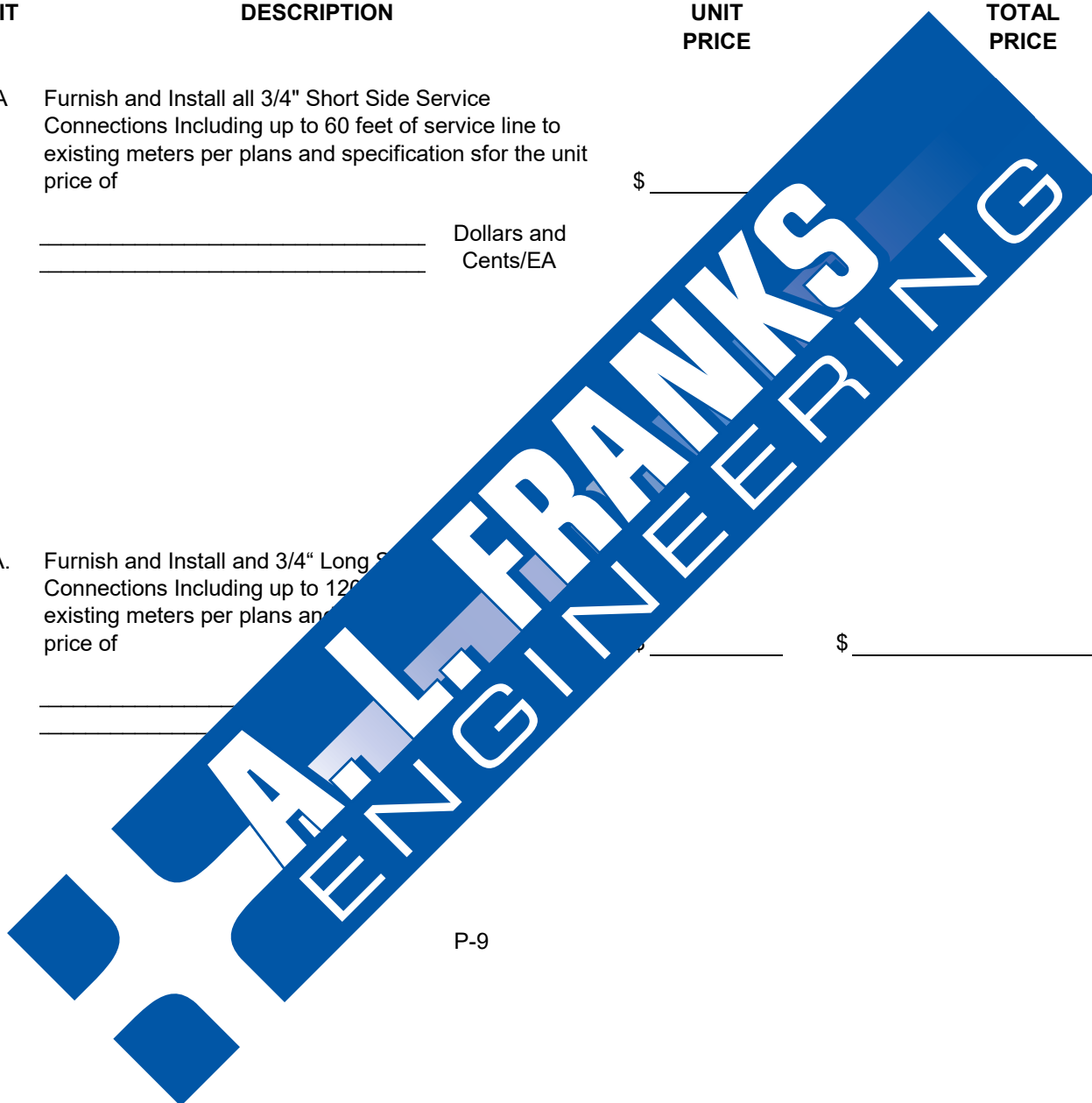

BID PROPOSAL CONTINUED

ITEM	QTY	UNIT	DESCRIPTION	UNIT PRICE	TOTAL PRICE
19	1	E.A.	Furnish and Install 3/4" Long Side Highway Service Connections by Directional Bore including up to 120 feet of service line, 2" PVC Encasement, to existing 3/4" meter per plans and specifications for the unit price of	\$ _____	_____
			_____ Dollars and Cents/EA		

20	500	L.F.	Open Cut and Repair Asphalt Surf plans and specifications for the	\$ _____	\$ _____

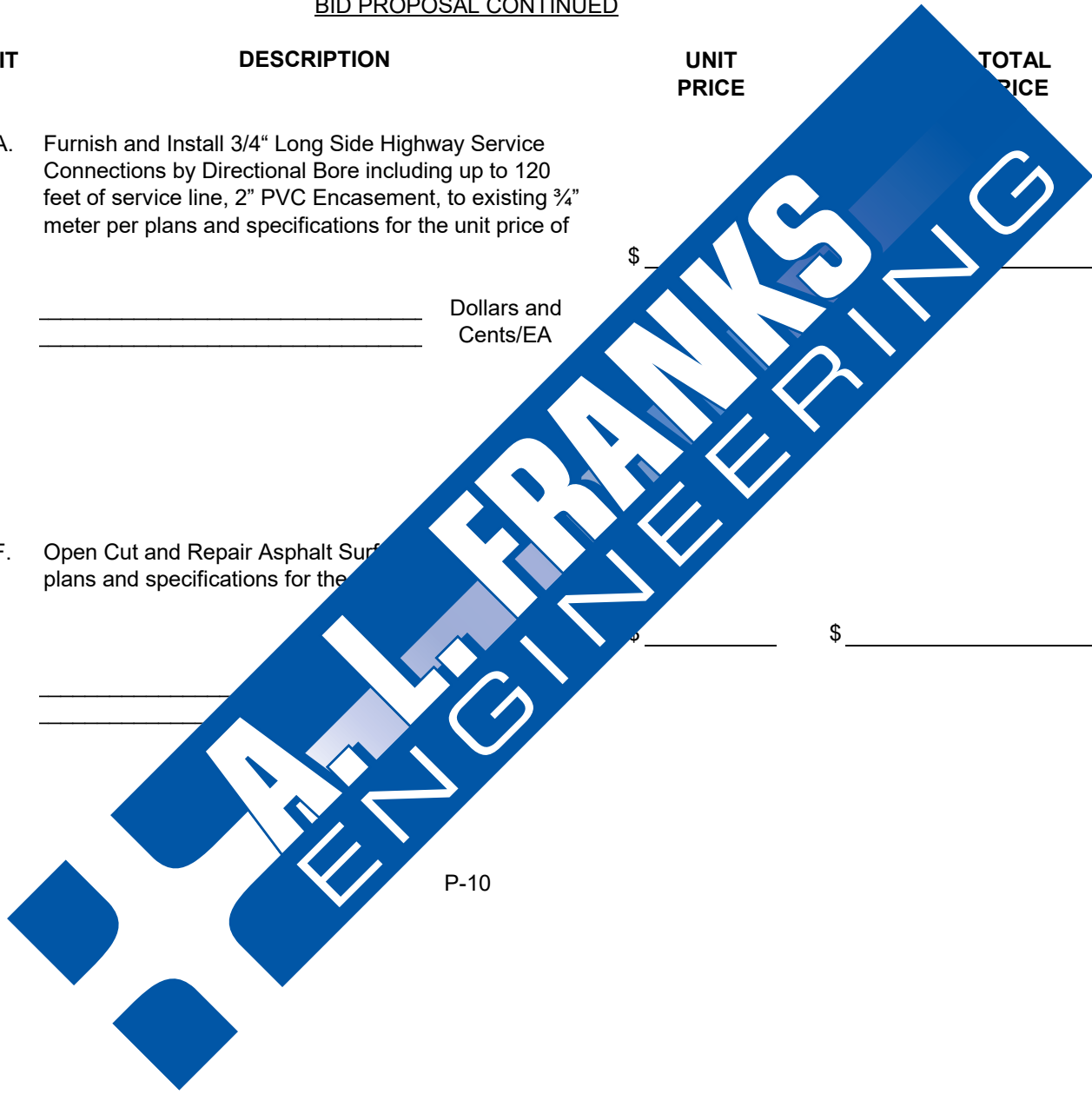

BID PROPOSAL CONTINUED

ITEM	QTY	UNIT	DESCRIPTION	UNIT PRICE	TOTAL PRICE
21	500	L.F.	Open Cut and Repair Concrete Surface per plans and specifications for the unit price of	\$ _____	_____
			_____ Dollars and		
			_____ Cents/LF		
22	1	LS	Trench Safety per plans and specifications for the lump sum price of	\$ _____	_____

23	1	LS	Furnish all labor and install all _____ and sterilization of treated _____ per plans and specifications	\$ _____	\$ _____
			_____ and _____		
			_____ s/LS		
			P-11		

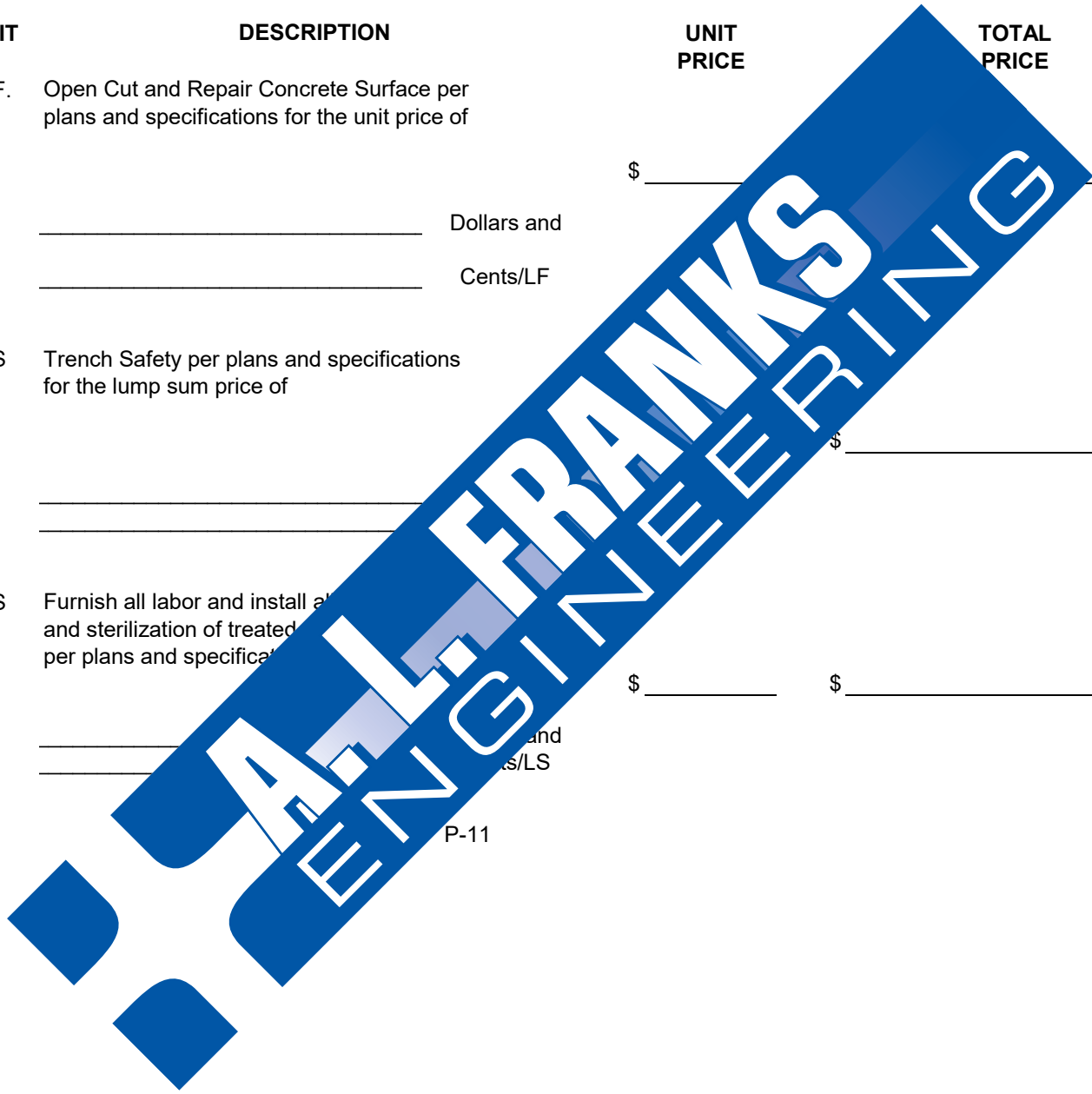

BID PROPOSAL CONTINUED

ITEM	QTY	UNIT	DESCRIPTION	UNIT PRICE	TOTAL PRICE
24	1	LS	Mobilization including preparatory work and operations, including but not limited to, movement of personnel, equipment, supplies, and incidentals to the project site for the lump sum price of	\$ _____	_____
			_____ Dollars and		
			_____ Cents/LS		
25	1	LS	Furnish and Install all equipment, materials to clear, grub and remove all brush, trees, existing right of way, including removal of fencing and portable structures or obstructions preventing the installation of sewer main as shown per plan for the lump sum price of	\$ _____	\$ _____
			_____ LS		
TOTAL ITEMS (1-25)				\$ _____	_____

NOTES

- 1) Miscellaneous items, dirt, etc., not specifically listed but required to complete the proposed improvements to a complete _____ shall be included in the Bid under the most appropriate Bid Item.
- 2) Time required to complete base _____, be 180 calendar days.
Contractor shall complete work by _____, 2026 or Liquidated Damages will be imposed and the completion of project will be solely at the expense of the Contractor.
- 3) Contractor is solely responsible for the complete abandonment of all existing mains unless otherwise noted.

CITY OF MCGEHEE, ARKANSAS

WATER DISTRIBUTION IMPROVEMENTS

MCG-03-26



BEFORE CONSTRUCTION BEGINS
GIVE 48 HOURS NOTICE
FOR UNDERGROUND UTILITY LOCATIONS
CALL: THE ARKANSAS ONE-CALL SYSTEM 1-800-482-8998

SUBMITTED BY:



118 E. Broad Street
Texarkana, Arkansas 71854
Phone (870) 216-1906
Fax (870) 216-1907

319 W. OAK STREET
El Dorado, Arkansas 71730
Phone (870) 444-5160



INDEX TO SHEETS

DESCRIPTION	SHEET NO.
COVER	1
GENERAL NOTES	2
INDEX MAP	3
PLUM ALLEY STA: 0+00-5+60 AND 10+00-12+50	4
WOLFE DR. STA: 15+00-35+10	5-7
NORTH ST. STA: 35+00-39+99 AND 45+00-47+00	8
NORTH ST. ALLEY STA: 47+00-53+40	9
THOMPSON ST. STA: 55+00-58+99	10
4TH STREET STA: 60+00-63+97	11
2ND STREET STA: 65+00-74+91	12
CONSTRUCTION DETAILS	13-14

901 HOLLY ST.
MCGEHEE, ARKANSAS 71654
PH: 870-222-3160

APPROVED BY:
CITY OF MCGEHEE, ARKANSAS



Cody J. Stringer
CODY J. STRINGER, P.E. PROJECT ENGINEER 3/20/2026 DATE

Kiron S. Browning
KIRON S. BROWNING, P.E. PROJECT ENGINEER 3-20-26 DATE



No.	Date	Revision	By



118 East Broad Street
 Texarkana, Arkansas 71854
 Phone (870) 216-1906
 Fax (870) 216-1907

101 West Main, Ste. 413
 El Dorado, Arkansas 71730
 Phone (870) 444-5160
 Fax (870) 444-5161

INDEX SHEET
CITY OF McGEHEE, ARKANSAS
WATERLINE IMPROVEMENTS

Job No.: MCG-03-06
 Scale: N.A.
 Date: JAN. 2026
 Sheet 3

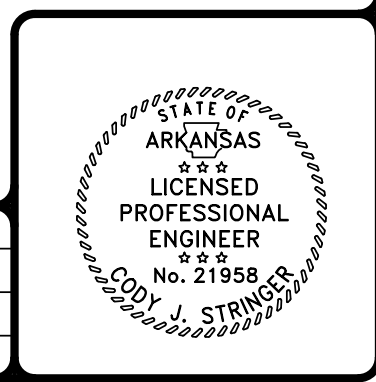

NOTE:
CONTRACTOR TO FURNISH AND INSTALL "LIKE" GRASS SEED OR SOD AS DIRECTED BY THE ENGINEER AT NO ADDITIONAL COST TO THE CITY.

CONTRACTOR TO CLEAR AND GRUB, REMOVE FENCE, PORTABLE BUILDINGS, ETC. TO INSTALL PROPOSED WATER MAINS.

FLUSH HYDRANT ASSEMBLY 0 THIS SHEET.

FIRE HYDRANT ASSEMBLY REMOVAL 0 THIS SHEET.

FIRE HYDRANT ASSEMBLY 1 THIS SHEET.

0 LONG SERVICES
6 SHORT SERVICES
THIS SHEET

FURNISH AND INSTALL HYDRANT ASSEMBLY

OPEN CUT STREET TO TIE IN PROP 6" PVC WATER MAIN, EXIST 6" WATER MAIN W/ 6" TEE, 1-FIRE HYDRANT ASSEMBLY, & 1-6"G.V.

DIRECTIONAL BORE OF 6" C-900 WATER MAIN.(40 LF)

FURNISH AND INSTALL 2" SDR 9 POLY PIPE.

EXISTING 1" MAIN TO BE ABANDONED. CUT AND CAP BOTH DIRECTIONS.

EXISTING 1" MAIN TO BE ABANDONED. CUT AND CAP BOTH DIRECTIONS.

EXISTING 10' R.O.W.

FURNISH AND INSTALL 6" C-900 PVC WATER MAIN

TIE IN PROP 6" PVC WATER MAIN, PROP 2" POLY PIPE, EXIST 6" WATER MAIN W/ 6" TEE, 1-6x2RED., 2-6"G.V., & 1-2"G.V.

STATION 10+00-12+50
SCALE: 1"=50'-0"

STATION 0+00-5+60
SCALE: 1"=50'-0"

LEGEND:

EXISTING WATER MAIN TO BE ABANDON IN PLACE	---
PROPOSED WATER MAIN	6W
EXISTING GATE VALVE	⊗
PROPOSED GATE VALVE W/ ADJ. VALVE BOX	⊗
PROPOSED 3/4" SERVICE LINE	□
DIRECTIONAL BORE	—
BORE AND ENCASEMENT	▨
PROPOSED FIRE HYDRANT ASSEMBLY	⊗FH
POWER POLE/FIBER OPTIC	•
PHONE BOX/GAS METER	□
MAN HOLE	○
CAP	⌈



No.	Date	Revision	By



118 East Broad Street
Texarkana, Arkansas 71854
Phone (870) 216-1906
Fax (870) 216-1907

101 West Main, Ste. 413
El Dorado, Arkansas 71730
Phone (870) 444-5160
Fax (870) 444-5161

PLUM ALLEY STA. 0+00-5+60 & STA. 10+00-12+50
CITY OF MCGEEHEE, ARKANSAS
WATERLINE IMPROVEMENTS

Job No.: MCG-03-26
Scale: 1"=50'
Date: JAN. 2026
Sheet 4



A.L. FRANKS ENGINEERING

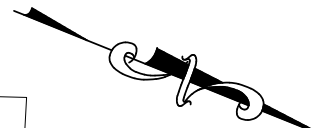
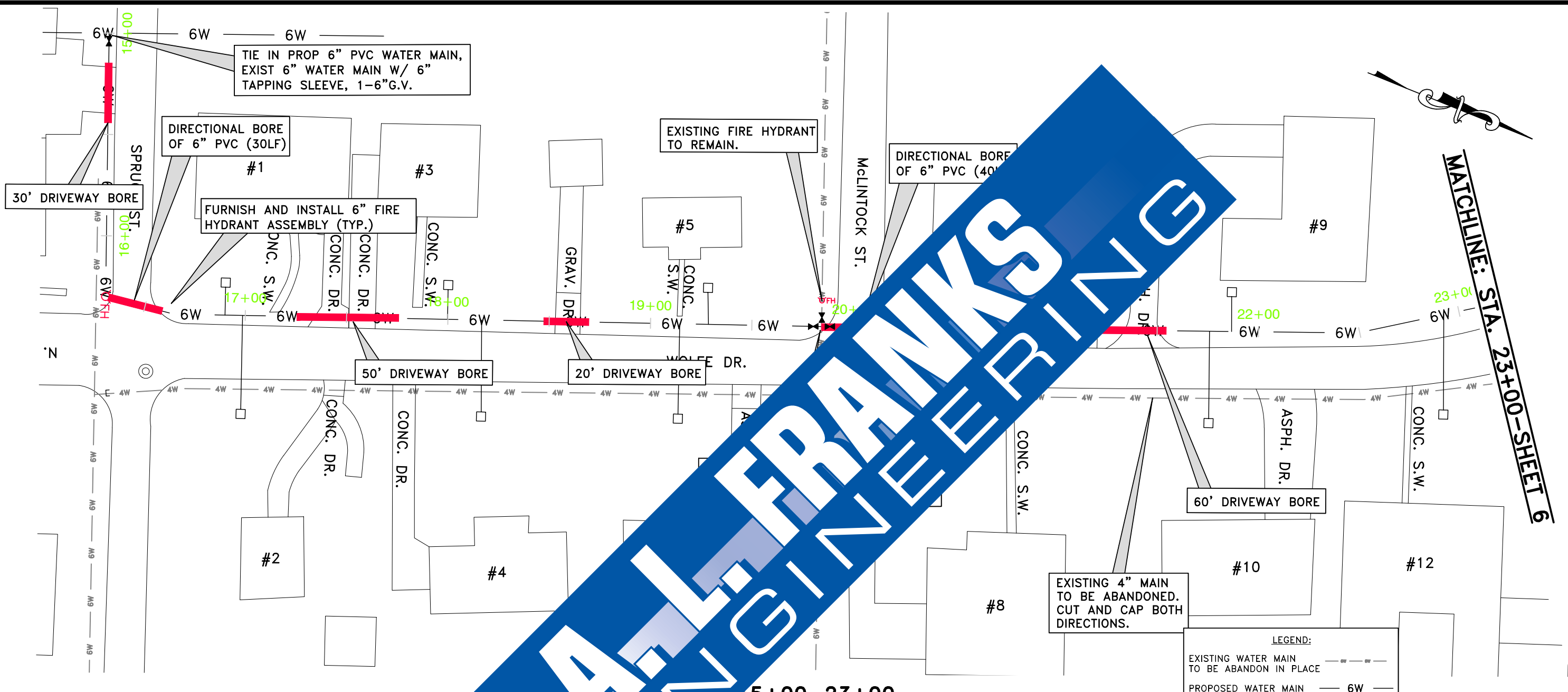

MATCHLINE: STA. 23+00-SHEET 6

15+00-23+00

NOTE:
CONTRACTOR TO FURNISH AND INSTALL "LIKE" GRASS SEED OR SOD AS DIRECTED BY THE ENGINEER AT NO ADDITIONAL COST TO THE CITY.

CONTRACTOR TO CLEAR AND GRUB, REMOVE FENCE, PORTABLE BUILDINGS, ETC. TO INSTALL PROPOSED WATER MAINS.

FLUSH HYDRANT ASSEMBLY OF THIS SHEET.

FIRE HYDRANT ASSEMBLY REMOVAL OF THIS SHEET.

FIRE HYDRANT ASSEMBLY OF THIS SHEET.

6 LONG SERVICES
5 SHORT SERVICES
THIS SHEET

LEGEND:

EXISTING WATER MAIN TO BE ABANDON IN PLACE	---
PROPOSED WATER MAIN	6W
EXISTING GATE VALVE	⊗
PROPOSED GATE VALVE W/ ADJ. VALVE BOX	⊗
PROPOSED 3/4" SERVICE LINE	□
DIRECTIONAL BORE	—
BORE AND ENCASEMENT	⊗
PROPOSED FIRE HYDRANT ASSEMBLY	⊗FH
POWER POLE/FIBER OPTIC	•
PHONE BOX/GAS METER	□
MAN HOLE	○
CAP	⌈

No.	Date	Revision	By
A	3/18/26	REVISED AS MARKED	LWH



118 East Broad Street
Texarkana, Arkansas 71854
Phone (870) 216-1906
Fax (870) 216-1907

101 West Main, Ste. 413
El Dorado, Arkansas 71730
Phone (870) 444-5160
Fax (870) 444-5161

WOLFE DR. STA. 15+00-22+00
CITY OF MCGEEHEE, ARKANSAS
WATERLINE IMPROVEMENTS

Job No.: MCG-03-26
Scale: 1"=50'
Date: JAN. 2026
Sheet 5



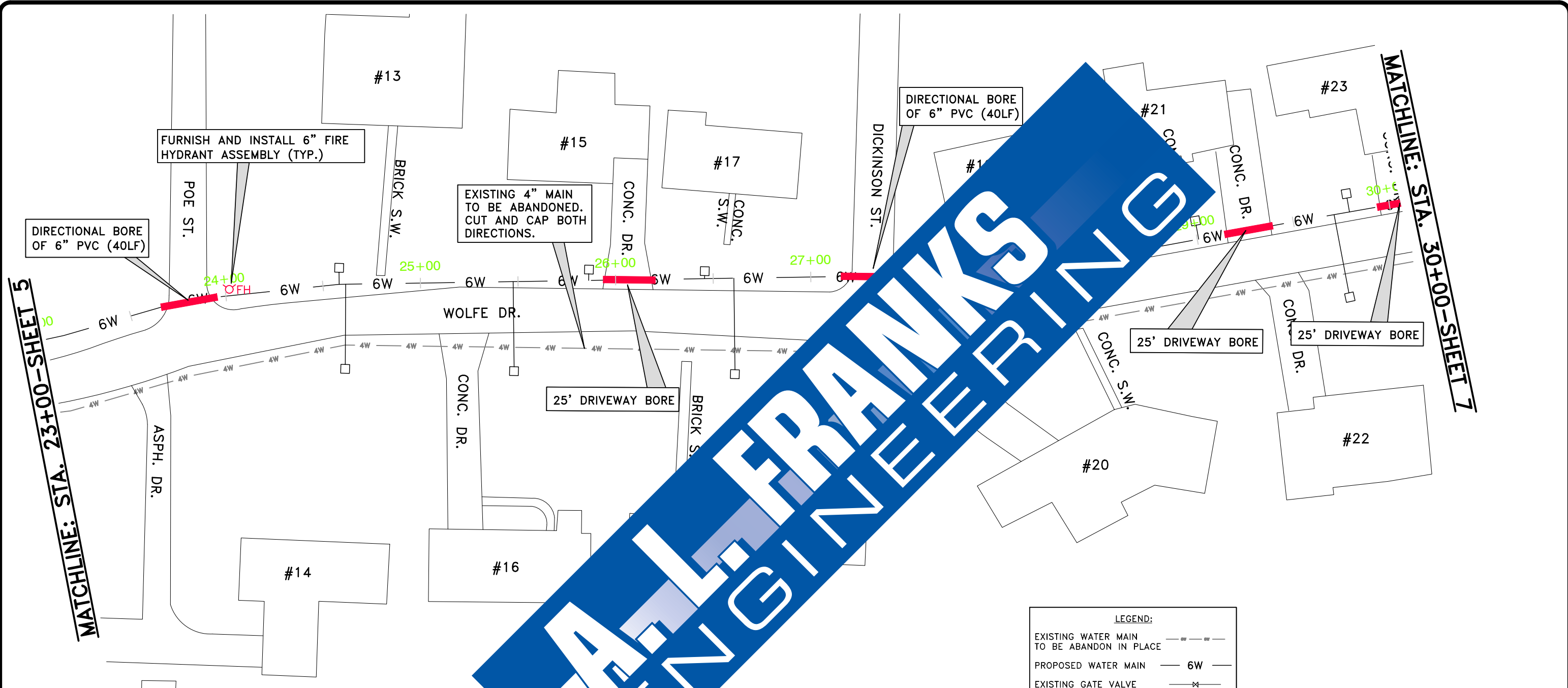

MATCHLINE: STA. 23+00-SHEET 5

MATCHLINE: STA. 30+00-SHEET 7

A.L. FRANKS ENGINEERING

SECTION 23+00-30+00
SCALE: 1"=50'-0"

NOTE:
CONTRACTOR TO FURNISH AND INSTALL "LIKE" GRASS SEED OR SOD AS DIRECTED BY THE ENGINEER AT NO ADDITIONAL COST TO THE CITY.

CONTRACTOR TO CLEAR AND GRUB, REMOVE FENCE, PORTABLE BUILDINGS, ETC. TO INSTALL PROPOSED WATER MAINS.

FLUSH HYDRANT ASSEMBLY THIS SHEET.

FIRE HYDRANT ASSEMBLY REMOVAL ON THIS SHEET.

FIRE HYDRANT ASSEMBLY THIS SHEET.

5 LONG SERVICES
6 SHORT SERVICES
THIS SHEET

LEGEND:	
EXISTING WATER MAIN TO BE ABANDON IN PLACE	--- ---
PROPOSED WATER MAIN	6W
EXISTING GATE VALVE	⊞
PROPOSED GATE VALVE W/ ADJ. VALVE BOX	⊞
PROPOSED 3/4" SERVICE LINE	□
DIRECTIONAL BORE	█
BORE AND ENCASEMENT	▨
PROPOSED FIRE HYDRANT ASSEMBLY	⊕FH
POWER POLE/FIBER OPTIC	•
PHONE BOX/GAS METER	□
MAN HOLE	○
CAP	⌈

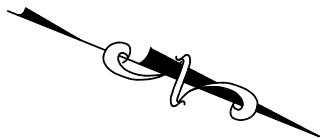

No.	Date	Revision	By
A	3/18/26	REVISED AS MARKED	LWH



118 East Broad Street
Texarkana, Arkansas 71854
Phone (870) 216-1906
Fax (870) 216-1907

101 West Main, Ste. 413
El Dorado, Arkansas 71730
Phone (870) 444-5160
Fax (870) 444-5161

WOLFE DR. STA. 22+00-29+00
CITY OF MCGEHEE, ARKANSAS
WATERLINE IMPROVEMENTS

Job No.: MCG-03-26
Scale: 1"=50'
Date: JAN. 2026
Sheet 6

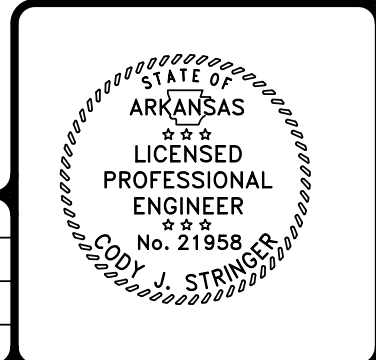

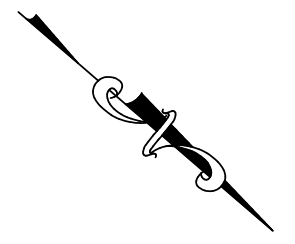

MATCHLINE: STA. 30+00 - SHEET 6

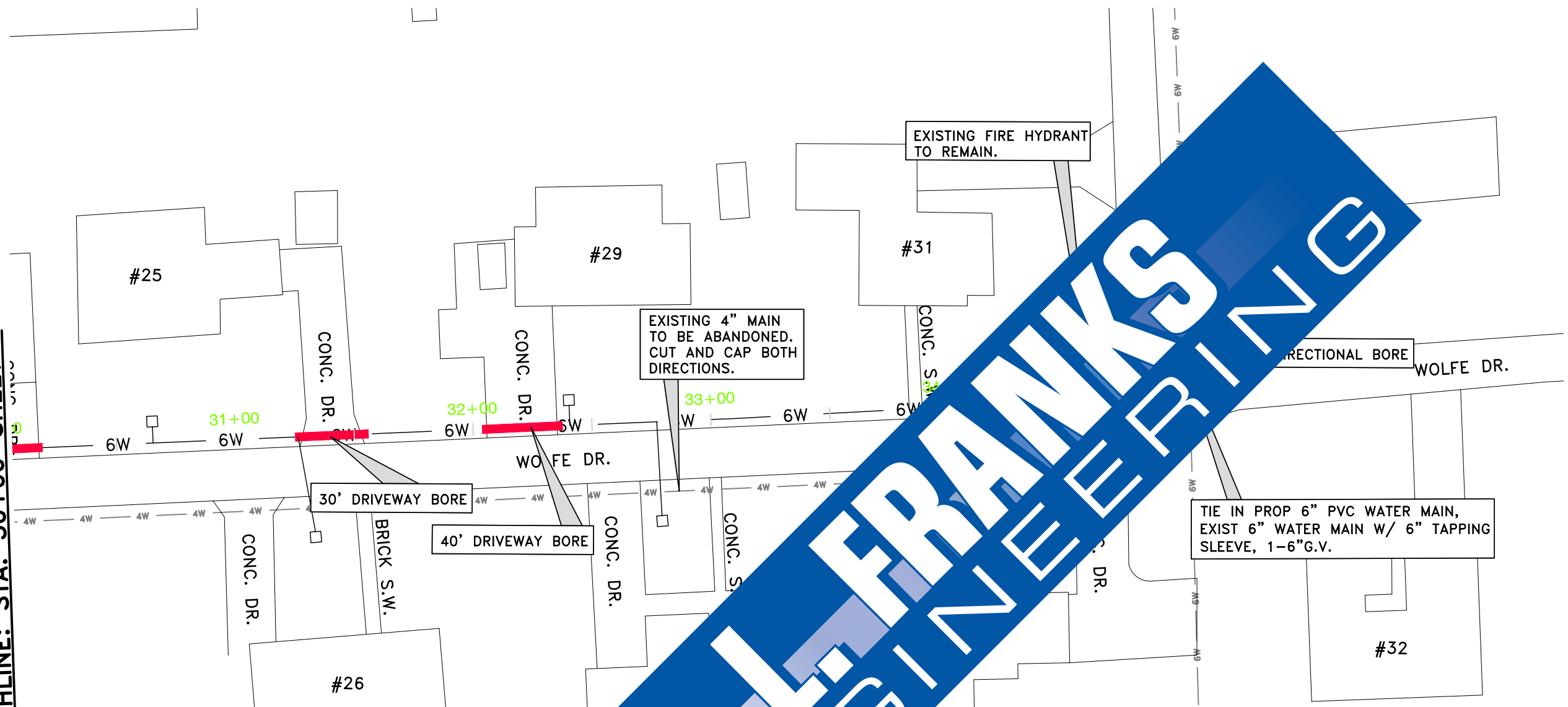

A. L. FRANKS ENGINEERING

NOTE:
CONTRACTOR TO FURNISH AND INSTALL "LIKE" GRASS SEED OR SOD AS DIRECTED BY THE ENGINEER AT NO ADDITIONAL COST TO THE CITY.

CONTRACTOR TO CLEAR AND GRUB, REMOVE FENCE, PORTABLE BUILDINGS, ETC. TO INSTALL PROPOSED WATER MAINS.

FLUSH HYDRANT ASSEMBLY OF THIS SHEET.
FIRE HYDRANT ASSEMBLY REMOVAL OF THIS SHEET.
FIRE HYDRANT ASS THIS SHEET.

3 LONG SERVICES
3 SHORT SERVICES
THIS SHEET

LEGEND:

EXISTING WATER MAIN TO BE ABANDON IN PLACE	---
PROPOSED WATER MAIN	6W
EXISTING GATE VALVE	⊗
PROPOSED GATE VALVE W/ ADJ. VALVE BOX	⊗
PROPOSED 3/4" SERVICE LINE	□
DIRECTIONAL BORE	—
BORE AND ENCASEMENT	---
PROPOSED FIRE HYDRANT ASSEMBLY	⊗FH
POWER POLE/FIBER OPTIC	•
PHONE BOX/GAS METER	□
MAN HOLE	○
CAP	[

No.	Date	Revision	By
A	3/18/26	REVISED AS MARKED	LWH



118 East Broad Street
Texarkana, Arkansas 71854
Phone (870) 216-1906
Fax (870) 216-1907

101 West Main, Ste. 413
El Dorado, Arkansas 71730
Phone (870) 444-5160
Fax (870) 444-5161

WOLFE DR. STA. 29+00-33+86
CITY OF MCGEHEE, ARKANSAS
WATERLINE IMPROVEMENTS

Job No.: MCG-03-26
Scale: 1"=50'
Date: JAN. 2026
Sheet 7

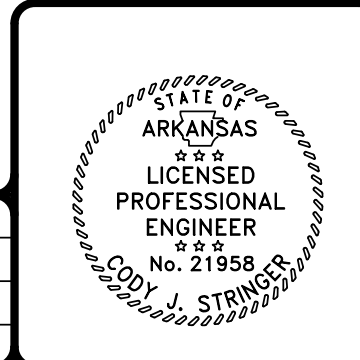

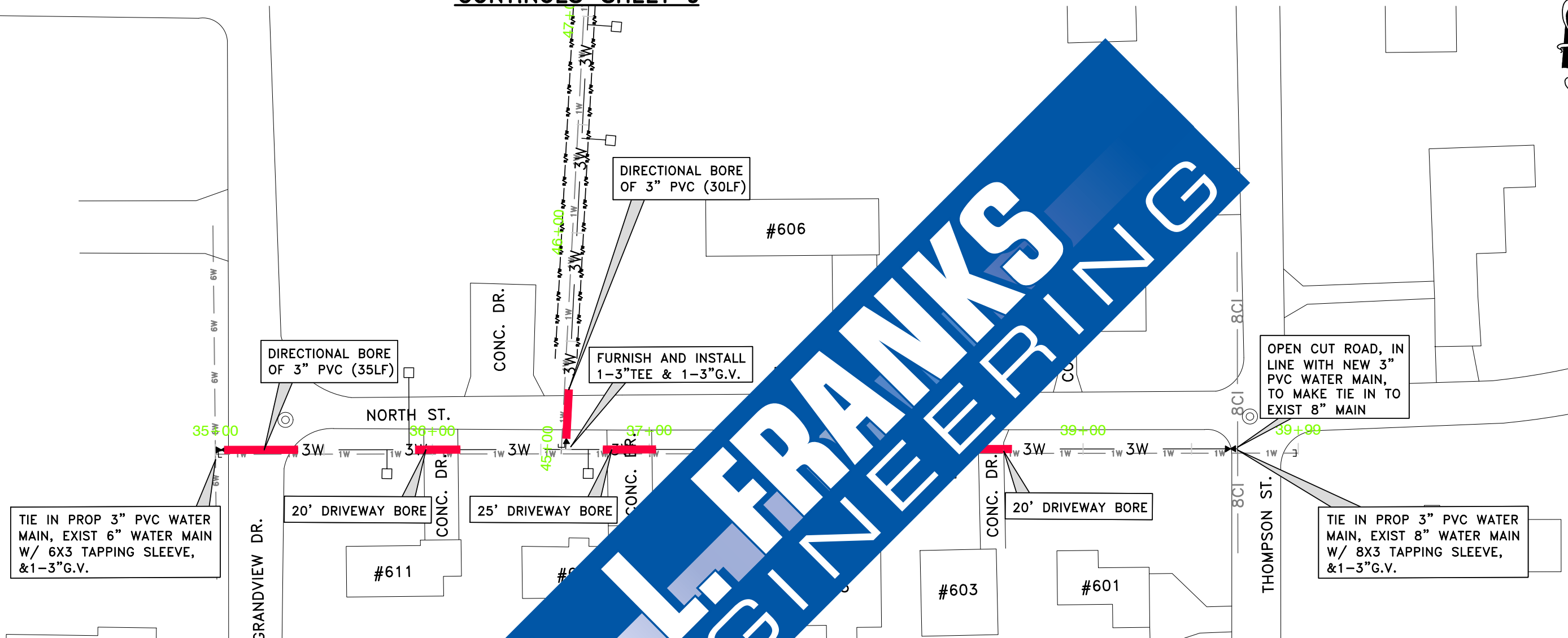

TIE IN PROP 3" PVC WATER MAIN, EXIST 6" WATER MAIN W/ 6X3 TAPPING SLEEVE, & 1-3" G.V.

DIRECTIONAL BORE OF 3" PVC (35LF)

DIRECTIONAL BORE OF 3" PVC (30LF)

FURNISH AND INSTALL 1-3" TEE & 1-3" G.V.

OPEN CUT ROAD, IN LINE WITH NEW 3" PVC WATER MAIN, TO MAKE TIE IN TO EXIST 8" MAIN

TIE IN PROP 3" PVC WATER MAIN, EXIST 8" WATER MAIN W/ 8X3 TAPPING SLEEVE, & 1-3" G.V.

NOTE:
CONTRACTOR TO FURNISH AND INSTALL "LIKE" GRASS SEED OR SOD AS DIRECTED BY THE ENGINEER AT NO ADDITIONAL COST TO THE CITY.

CONTRACTOR TO CLEAR AND GRUB, REMOVE FENCE, PORTABLE BUILDINGS, ETC. TO INSTALL PROPOSED WATER MAINS.

FLUSH HYDRANT ASSEMBLY THIS SHEET.
FIRE HYDRANT ASSEMBLY REMOVAL OF THIS SHEET.
FIRE HYDRANT ASSEMBLY THIS SHEET.

2 LONG SERVICES
6 SHORT SERVICES
THIS SHEET

STATION 35+00-39+99
SCALE: 1"=50'-0"

LEGEND:

EXISTING WATER MAIN TO BE ABANDON IN PLACE	----
PROPOSED WATER MAIN	— 6W —
EXISTING GATE VALVE	— X —
PROPOSED GATE VALVE W/ ADJ. VALVE BOX	— X —
PROPOSED 3/4" SERVICE LINE	□ —
DIRECTIONAL BORE	—
BORE AND ENCASEMENT	—
PROPOSED FIRE HYDRANT ASSEMBLY	⊙ FH
POWER POLE/FIBER OPTIC	•
PHONE BOX/GAS METER	□
MAN HOLE	○
CAP	⌈

No.	Date	Revision	By
A	3/18/26	REVISED AS MARKED	LWH



118 East Broad Street
Texarkana, Arkansas 71854
Phone (870) 216-1906
Fax (870) 216-1907

101 West Main, Ste. 413
El Dorado, Arkansas 71730
Phone (870) 444-5160
Fax (870) 444-5161

NORTH ST. STA. 35+00-39+99
CITY OF MCGEE, ARKANSAS
WATERLINE IMPROVEMENTS

Job No.: MCG-03-26
Scale: 1"=50'
Date: JAN. 2026
Sheet 8



GRANDVIEW DR.

GRANDVIEW DR.

WILLOW ST.

HEMLOCK ST.

CONTINUES - SHEET 8

EXISTING 1" MAIN TO BE ABANDONED. CUT AND CAP BOTH DIRECTIONS.

DIRECTIONAL BORE OF 3" PVC (30LF)

EXISTING 10' R.O.W.

DIRECTIONAL BORE OF 3" PVC (30LF)

TIE IN PROP 3" PVC WATER MAIN, EXIST 6" WATER MAIN W/ 1-6" CROSS, 2-6x3RED., 2-6"G.V., & 1-3"G.V.

TIE IN PROP 3" PVC WATER MAIN, EXIST 4" PVC WATER MAIN W/ 4" TAPPING SLEEVE & 1-3"G.V.

NOTE: CONTRACTOR TO FURNISH AND INSTALL "LIKE" GRASS SEED OR SOD AS DIRECTED BY THE ENGINEER AT NO ADDITIONAL COST TO THE CITY.

CONTRACTOR TO CLEAR AND GRUB, REMOVE FENCE, PORTABLE BUILDINGS, ETC. TO INSTALL PROPOSED WATER MAINS.

0 LONG SERVICES
10 SHORT SERVICES
THIS SHEET

FLUSH HYDRANT ASSEMBLY OF THIS SHEET.

FIRE HYDRANT ASSEMBLY REMOVAL OF THIS SHEET.

FIRE HYDRANT ASSEMBLY OF THIS SHEET.

LEGEND:

EXISTING WATER MAIN TO BE ABANDON IN PLACE	---
PROPOSED WATER MAIN	6W
EXISTING GATE VALVE	⊗
PROPOSED GATE VALVE W/ ADJ. VALVE BOX	⊗
PROPOSED 3/4" SERVICE LINE	□
DIRECTIONAL BORE	—
BORE AND ENCASEMENT	▨
PROPOSED FIRE HYDRANT ASSEMBLY	⊗FH
POWER POLE/FIBER OPTIC	•
PHONE BOX/GAS METER	□
MAN HOLE	○
CAP	⌈



47+00-53+40



118 East Broad Street
Texarkana, Arkansas 71854
Phone (870) 216-1906
Fax (870) 216-1907

101 West Main, Ste. 413
El Dorado, Arkansas 71730
Phone (870) 444-5160
Fax (870) 444-5161

ALLEY NORTH TO HEMLOCK STA. 47+00-53+40
CITY OF MCGEHEE, ARKANSAS
WATERLINE IMPROVEMENTS

Job No.: MCG-03-26
Scale: 1"=50'
Date: JAN. 2026
Sheet 9



No.	Date	Revision	By
A	3/18/26	REVISED AS MARKED	LWH

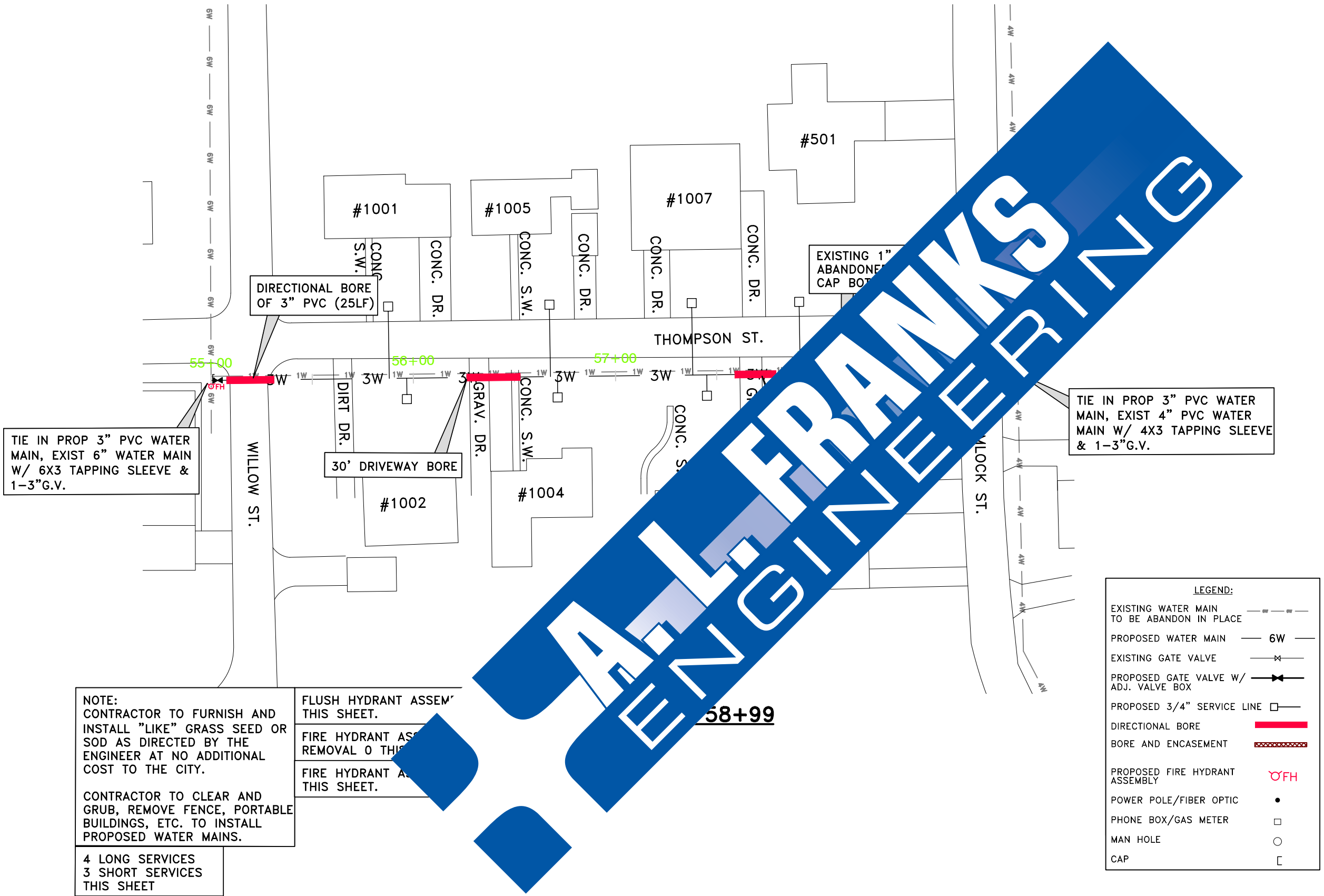

TIE IN PROP 3" PVC WATER MAIN, EXIST 6" WATER MAIN W/ 6X3 TAPPING SLEEVE & 1-3"G.V.

DIRECTIONAL BORE OF 3" PVC (25LF)

30' DRIVEWAY BORE

EXISTING 1" ABANDONED CAP BOT

TIE IN PROP 3" PVC WATER MAIN, EXIST 4" PVC WATER MAIN W/ 4X3 TAPPING SLEEVE & 1-3"G.V.

NOTE:
CONTRACTOR TO FURNISH AND INSTALL "LIKE" GRASS SEED OR SOD AS DIRECTED BY THE ENGINEER AT NO ADDITIONAL COST TO THE CITY.

CONTRACTOR TO CLEAR AND GRUB, REMOVE FENCE, PORTABLE BUILDINGS, ETC. TO INSTALL PROPOSED WATER MAINS.

4 LONG SERVICES
3 SHORT SERVICES
THIS SHEET

FLUSH HYDRANT ASSEM' THIS SHEET.

FIRE HYDRANT ASSEM' REMOVAL 0 THIS SHEET.

FIRE HYDRANT ASSEM' THIS SHEET.

LEGEND:

EXISTING WATER MAIN TO BE ABANDON IN PLACE	---
PROPOSED WATER MAIN	6W
EXISTING GATE VALVE	X
PROPOSED GATE VALVE W/ ADJ. VALVE BOX	X
PROPOSED 3/4" SERVICE LINE	□
DIRECTIONAL BORE	—
BORE AND ENCASEMENT	---
PROPOSED FIRE HYDRANT ASSEMBLY	⊙FH
POWER POLE/FIBER OPTIC	•
PHONE BOX/GAS METER	□
MAN HOLE	○
CAP	⌈

No.	Date	Revision	By
A	3/18/26	REVISED AS MARKED	LWH

118 East Broad Street
Texarkana, Arkansas 71854
Phone (870) 216-1906
Fax (870) 216-1907

101 West Main, Ste. 413
El Dorado, Arkansas 71730
Phone (870) 444-5160
Fax (870) 444-5161

THOMPSON ST. STA. 55+00-58+99
CITY OF MCGEHEE, ARKANSAS
WATERLINE IMPROVEMENTS

Job No.: MCG-03-26
Scale: 1"=50'
Date: JAN. 2026
Sheet 10



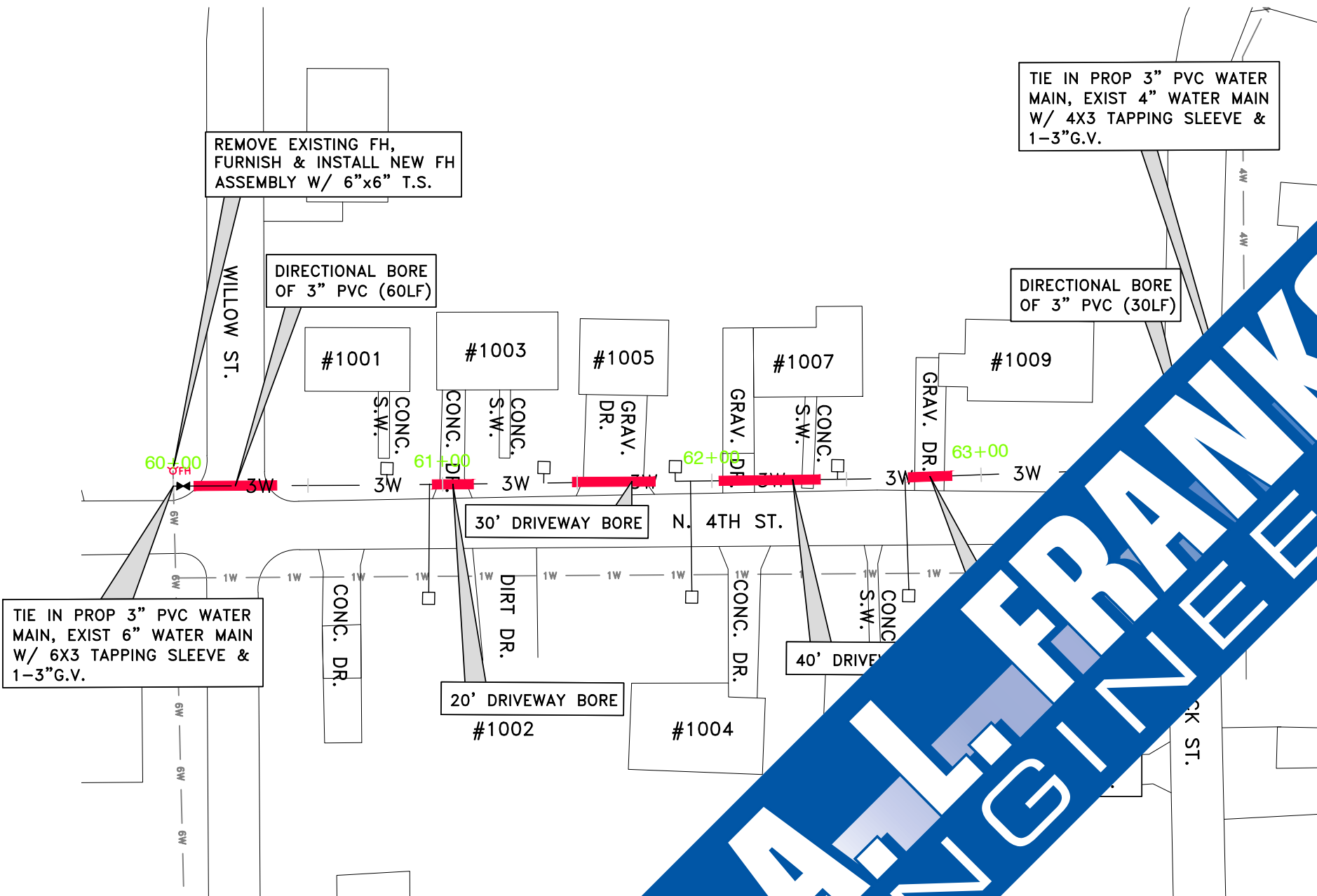
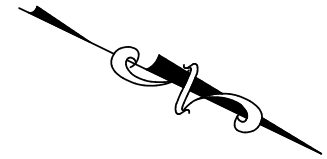

REMOVE EXISTING FH,
FURNISH & INSTALL NEW FH
ASSEMBLY W/ 6"x6" T.S.

DIRECTIONAL BORE
OF 3" PVC (60LF)

TIE IN PROP 3" PVC WATER
MAIN, EXIST 4" WATER MAIN
W/ 4X3 TAPPING SLEEVE &
1-3"G.V.

DIRECTIONAL BORE
OF 3" PVC (30LF)

TIE IN PROP 3" PVC WATER
MAIN, EXIST 6" WATER MAIN
W/ 6X3 TAPPING SLEEVE &
1-3"G.V.

30' DRIVEWAY BORE

20' DRIVEWAY BORE
#1002

40' DRIVEWAY BORE

NOTE:
CONTRACTOR TO FURNISH AND
INSTALL "LIKE" GRASS SEED OR
SOD AS DIRECTED BY THE
ENGINEER AT NO ADDITIONAL
COST TO THE CITY.

CONTRACTOR TO CLEAR AND
GRUB, REMOVE FENCE, PORTABLE
BUILDINGS, ETC. TO INSTALL
PROPOSED WATER MAINS.

3 LONG SERVICES
4 SHORT SERVICES
THIS SHEET

FLUSH HYDRANT ASSEMBLY
THIS SHEET.

FIRE HYDRANT ASSEMBLY
REMOVAL 1 THIS SHEET.

FIRE HYDRANT ASSEMBLY
REMOVAL 1 THIS SHEET.

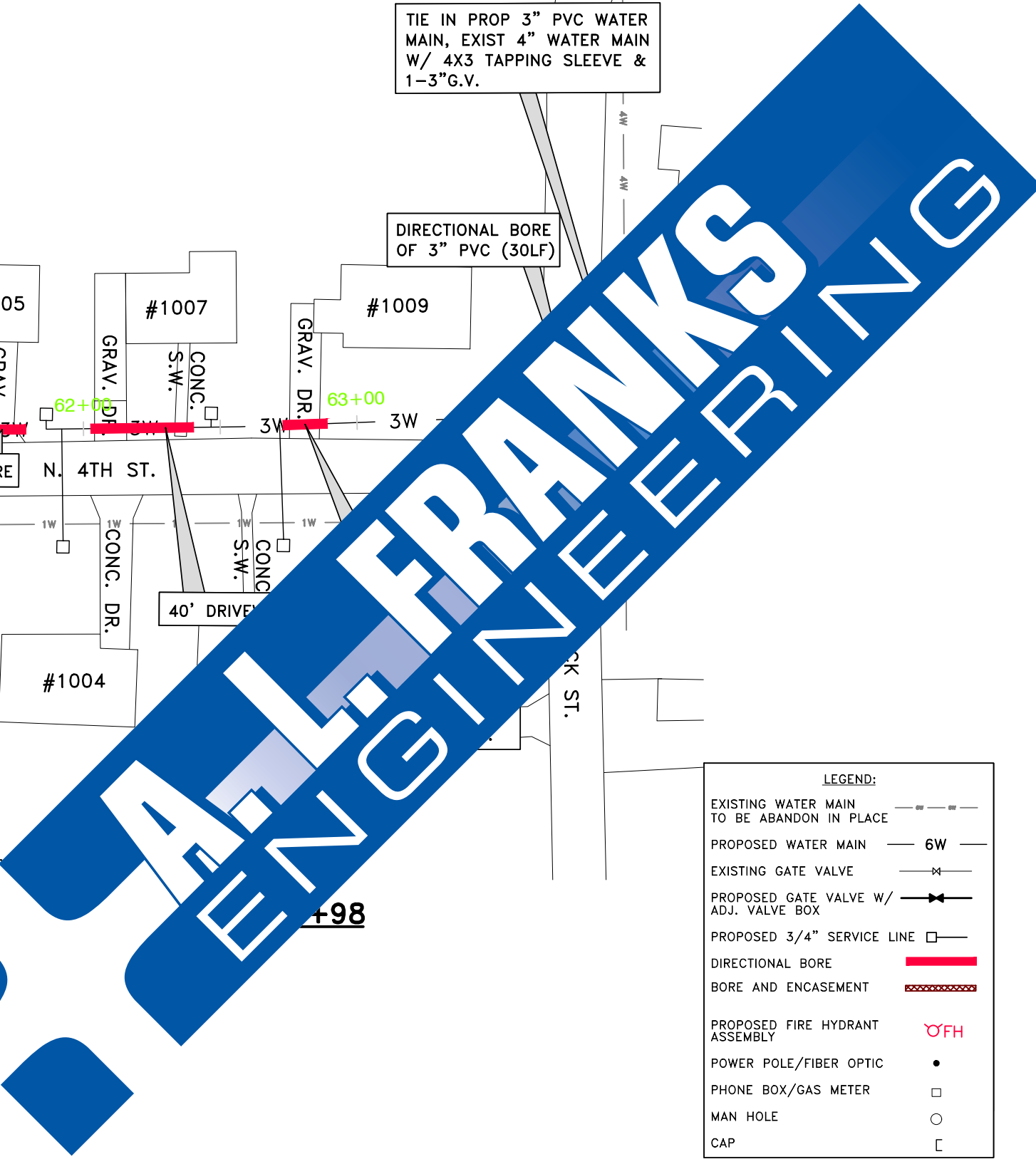

LEGEND:

EXISTING WATER MAIN TO BE ABANDON IN PLACE	---
PROPOSED WATER MAIN	— 6W —
EXISTING GATE VALVE	— X —
PROPOSED GATE VALVE W/ ADJ. VALVE BOX	— X —
PROPOSED 3/4" SERVICE LINE	□ —
DIRECTIONAL BORE	—
BORE AND ENCASEMENT	—
PROPOSED FIRE HYDRANT ASSEMBLY	⊙FH
POWER POLE/FIBER OPTIC	•
PHONE BOX/GAS METER	□
MAN HOLE	○
CAP	[

No.	Date	Revision	By
A	3/18/26	REVISED AS MARKED	LWH



118 East Broad Street
Texarkana, Arkansas 71854
Phone (870) 216-1906
Fax (870) 216-1907

101 West Main, Ste. 413
El Dorado, Arkansas 71730
Phone (870) 444-5160
Fax (870) 444-5161

4TH STREET STA. 60+00-63+98
CITY OF MCGEHEE, ARKANSAS
WATERLINE IMPROVEMENTS

Job No.: MCG-03-26
Scale: 1"=50'
Date: JAN. 2026
Sheet 11



TIE IN PROP 3" PVC WATER MAIN, EXIST 6" WATER MAIN W/ 6X3 TAPPING SLEEVE & 1-3"G.V.

DIRECTIONAL BORE OF 3" PVC (45LF)

DIRECTIONAL BORE OF 3" PVC (120LF)

DIRECTIONAL BORE OF 3" PVC (260LF)

DIRECTIONAL BORE OF 3" PVC (150LF)

EXISTING PORTABLE BUILDING ~ 2' FROM ROAD, TO BE BORED UNDER

EXISTING 2" MAIN TO BE ABANDONED. CUT AND CAP BOTH DIRECTIONS.

CONTRACTOR TO SAW CUT CONCRETE 90°, FROM NEW PVC MAIN TO ANY & ALL EXISTING METERS, TO REPLACE SERVICE TAPS FROM METERS TO MAIN. (TYPICAL)

OPEN CUT HIGHWAY, TO EXIST 8" MAIN, REPAIR/REPLACE IN KIND

FLUSH HYDRANT ASSEMBLY 0 THIS SHEET.

FIRE HYDRANT ASSEMBLY REMOVAL 0 THIS SHEET.

FIRE HYDRANT ASSEMBLY 0 THIS SHEET.

NOTE:
CONTRACTOR TO FURNISH AND INSTALL "LIKE" GRASS SEED OR SOD AS DIRECTED BY THE ENGINEER AT NO ADDITIONAL COST TO THE CITY.

CONTRACTOR TO CLEAR AND GRUB, REMOVE FENCE, PORTABLE BUILDINGS, ETC. TO INSTALL PROPOSED WATER MAINS.

1 LONG SERVICES (HIGHWAY)
12 SHORT SERVICES
THIS SHEET

TIE IN PROP 3" PVC WATER MAIN, EXIST 8" WATER MAIN W/ 8X3 TAPPING SLEEVE & 1-3"G.V.

1" HIGHWAY LONG SERVICE METER

OPEN 3" PVC

NEW STATION 72+00-74+91
SCALE: 1"=50'-0"

STATION 65
SCALE: 1"=50'-0"

MATCHLINE: STA. 70+50-THIS SHEET

MATCHLINE: STA. 70+50-THIS SHEET

LEGEND:

EXISTING WATER MAIN TO BE ABANDON IN PLACE	---
PROPOSED WATER MAIN	6W
EXISTING GATE VALVE	X
PROPOSED GATE VALVE W/ ADJ. VALVE BOX	X
PROPOSED 3/4" SERVICE LINE	□
DIRECTIONAL BORE	—
BORE AND ENCASEMENT	—
PROPOSED FIRE HYDRANT ASSEMBLY	⊕FH
POWER POLE/FIBER OPTIC	•
PHONE BOX/GAS METER	□
MAN HOLE	○
CAP	⌈

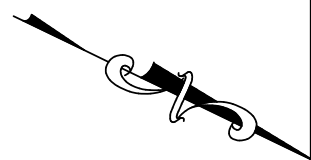

A.L. FRANKS ENGINEERING

No.	Date	Revision	By
A	3/18/26	REVISED AS MARKED	LWH



118 East Broad Street
Texarkana, Arkansas 71854
Phone (870) 216-1906
Fax (870) 216-1907

101 West Main, Ste. 413
El Dorado, Arkansas 71730
Phone (870) 444-5160
Fax (870) 444-5161

2ND STREET STA. 65+00-74+91
CITY OF MCGEEHEE, ARKANSAS
WATERLINE IMPROVEMENTS

Job No.: MCG-03-26
Scale: 1"=50'
Date: JAN. 2026
Sheet 12



GENERAL NOTES

1. A 3'-0" MIN. BURY SHALL BE MAINTAINED ON WATER MAIN.
2. CONTRACTOR SHALL BE RESPONSIBLE FOR DAMAGE TO EXISTING STRUCTURES, PIPING, CONDUIT, ETC. RESULTING FROM CONSTRUCTION WHETHER SHOWN ON THESE DRAWINGS OR NOT.
3. CONTRACTOR SHALL PERFORM FINISH GRADING, TOP SOILING AND ESTABLISHMENT OF GRASS COVER IN ALL DISTURBED AREAS PER PLANS AND SPECIFICATIONS, OR AS DIRECTED BY THE ENGINEER.
4. ALL WATER MAINS TO BE TESTED PER PLANS AND SPECIFICATIONS.
5. CONTRACTOR SHALL HAVE UTILITIES LOCATED AND SHALL BE RESPONSIBLE FOR DAMAGE TO ALL UTILITIES ARISING FROM CONTRACTORS WORK, REGARDLESS OF BEING SHOWN OR OMITTED FROM THESE DRAWINGS. SHOWN UTILITIES ARE INDICATED IN APPROX. LOCATIONS ONLY.
6. ALL DEBRIS SHALL BE DISPOSED OF PER SPECIFICATIONS OR AS DIRECTED BY THE ENGINEER.
7. THE MINIMUM SEPARATION DISTANCES SHALL BE ADHERED TO AS NOTED IN NOTE 3 OF SHEET 2 REGARDING WATER AND AND SEWER MAINS.
8. CONTRACTOR SHALL ABIDE BY ADH NOTE 3 ON SHEET 2 AS IT RELATES TO SEPARATION DISTANCES AND CONTAMINATION.
9. CONTRACTOR SHALL RESTRICT ALL OPERATIONS INSIDE OF CONSTRUCTION EASEMENT. ACCESS PERMISSION ACROSS ADJACENT PROPERTIES SHALL BE OBTAINED BY CONTRACTOR. ANY DAMAGE SHALL BE THE RESPONSIBILITY OF THE CONTRACTOR.
10. CONTRACTOR SHALL EXPOSE EXISTING UTILITIES IN ADVANCE OF CONSTRUCTION. GRADE ADJUSTMENTS SHALL BE APPROVED BY THE ENGINEER. COSTS ASSOCIATED w/ NOT EXPOSING EXISTING UTILITIES TO ALLOW GRADE ADJUSTMENT SHALL BE THE RESPONSIBILITY OF THE CONTRACTOR.
11. CONTRACTOR SHALL INSTALL 12 GAUGE COATED COPPER TRACER WIRE ON ALL WATER MAINS. TRACER WIRE SHALL LOOP CONTINUOUSLY THROUGH SERVICES AND VALVE BOXES AS SHOWN ON DETAIL. GEL-PAKS SHALL BE USED FOR ALL SPLICES.
12. ALL WATER MAIN VALVES AND FITTINGS SHALL BE DUCTILE IRON w/ MECHANICAL JOINTS.
13. ALL JACK AND BORES TO BE DUCTILE IRON.
14. CONSTRUCTION STAKING FOR CENTER LINE OF WATER MAIN ALONG U.S. HIGHWAYS WILL BE CONTRACTORS RESPONSIBILITY.
15. ALL BENDS, FITTINGS, VALVES & FIRE HYDRANTS SHALL BE BLOCKED PER DETAILS.
16. M.J. BENDS SHALL BE UTILIZED WHERE ALLOWABLE DEFLECTION WOULD BE EXCEEDED.
17. ALL WATER MAIN VALVES TO BE INSTALLED w/ ADJ. VALVE BOXES & CONCRETE STABILIZATION PADS.
18. FIRE HYDRANTS TO BE LOCATED ON PROPERTY CORNERS PLUMB & AT HEIGHT DIRECTED BY ENGINEER.
19. ALL BENDS NECESSARY TO MEET DEFLECTION REQUIREMENTS AND ASSOCIATED BLOCKING SHALL BE INCLUDED IN BID.

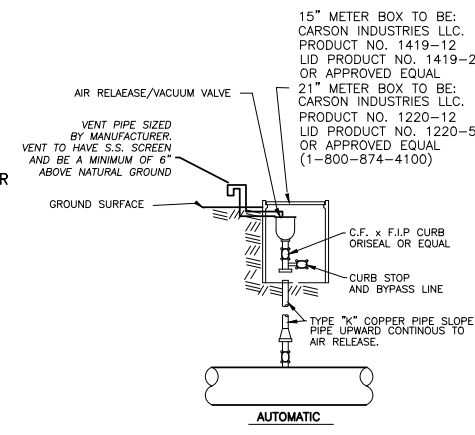

NOTE: 1. ALL THREADED CONNECTIONS SHALL HAVE A DOUBLE WRAP OF 3-MIL TEFLON TAPE ON THE THREAD.
2. VALVES WILL BE PIPED TO POINT BEYOND PAVEMENT AND SHOULDER. PIPING SHALL BE SLOPED CONSTANTLY UPWARD TO AIR RELEASE VALVE.

AIR/VACUUM RELEASE VALVE DETAILS
N.T.S.

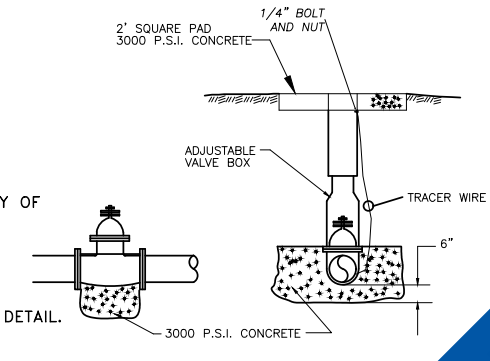

BLOCKING DETAILS FOR VALVE
N.T.S.

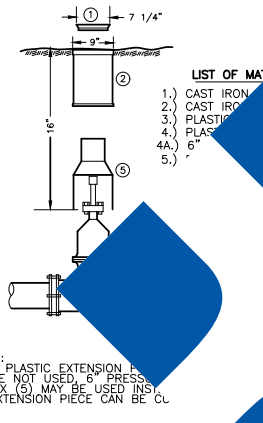

NOTES:
1.) IF PLASTIC EXTENSION PIECES ARE NOT USED, 6\"/>

VALVE ASSEMBLY
N.T.S.

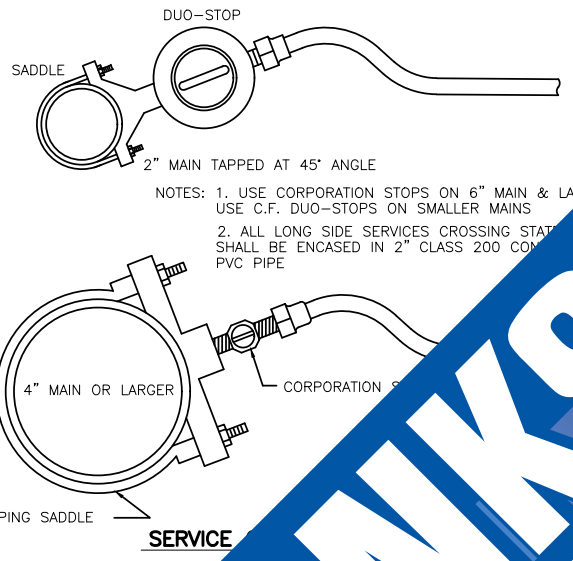

NOTES: 1. USE CORPORATION STOPS ON 6\"/>

SERVICE TAPPING SADDLE
N.T.S.

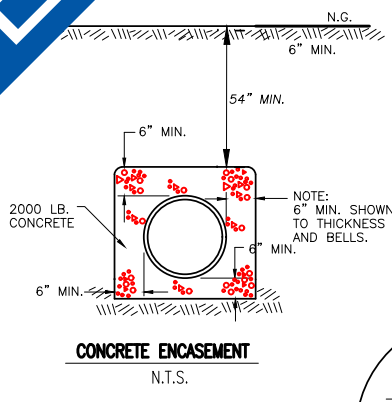

CONCRETE ENCASEMENT
N.T.S.

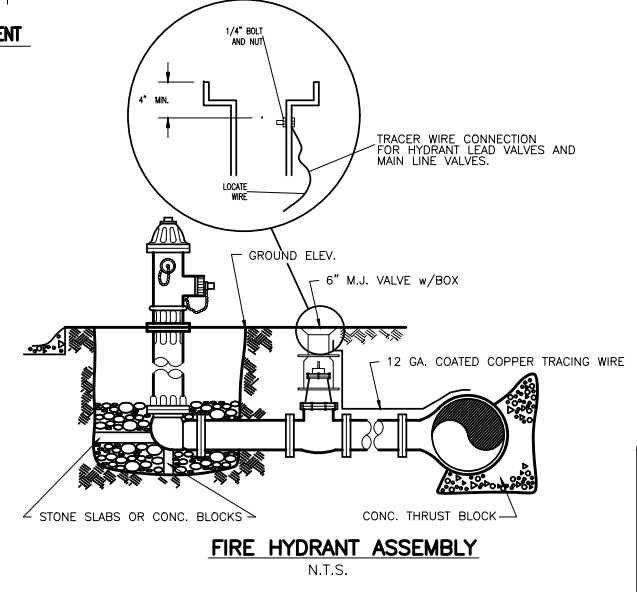

FIRE HYDRANT ASSEMBLY
N.T.S.

NOTES CONCERNING FIRE HYDRANTS:
1. DRAINAGE BED SHALL CONSIST OF CRUSHED STONE OR COURSE GRAVEL w/ COURSE SAND, MIN. VOLUME 7 CU. FT. DRAIN BED SHALL EXTEND A MIN. 6\"/>

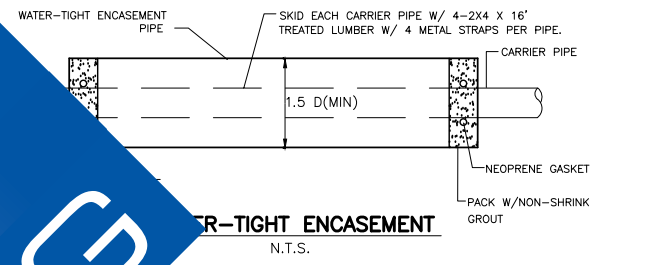

WATER-TIGHT ENCASEMENT
N.T.S.

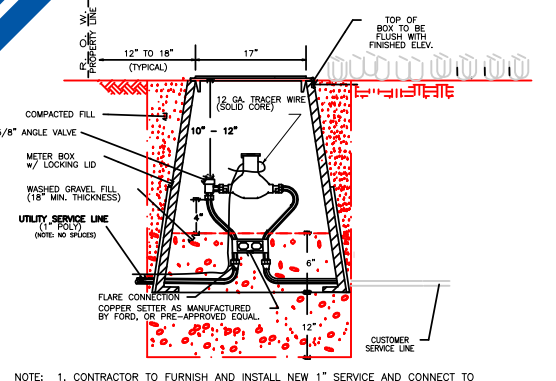

NOTE: 1. CONTRACTOR TO FURNISH AND INSTALL NEW 1\"/>

PROPOSED WATER METER CONNECTION DETAIL
N.T.S.

No.	Date	Revision	By



118 East Broad Street
Texarkana, Arkansas 71854
Phone (870) 216-1906
Fax (870) 216-1907

101 West Main, Ste. 413
El Dorado, Arkansas 71730
Phone (870) 444-5160
Fax (870) 444-5161

CONSTRUCTION DETAILS
CITY OF MCGEE, ARKANSAS
WATERLINE IMPROVEMENTS

Job No.: MCG-03-26
Scale: N.T.S.
Date: JAN. 2026
Sheet 13



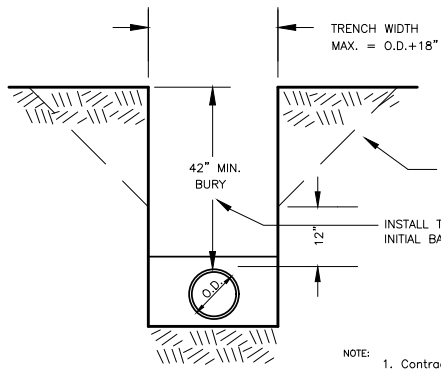

TYPICAL TRENCH SECTION
N.T.S.

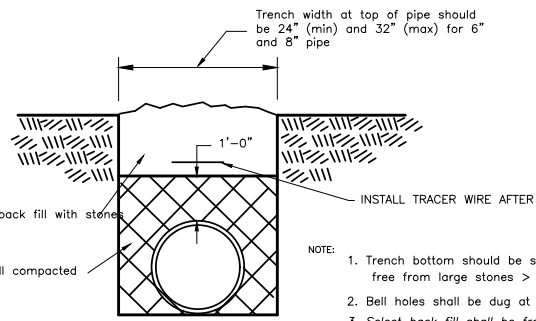

TYPE 1 LAYING CONDITION
(USE UNDER NORMAL CONDITIONS)

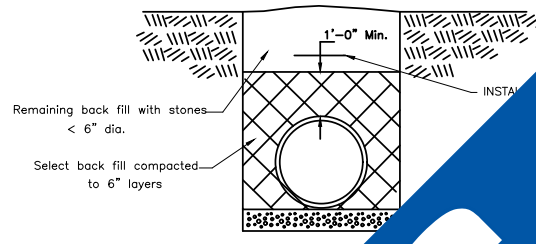

TYPE 2 LAYING CONDITION
(USE FOR ROCKY TRENCH BOTTOM)

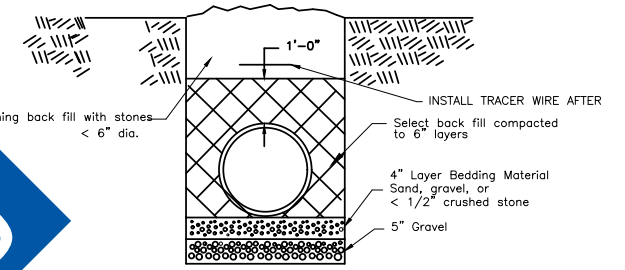

TYPE 3 LAYING CONDITION
(USE FOR SOFT OR WET TRENCH BOTTOM)

GENERAL DATA FOR BLOCKING STANDARD FITTING

PIPE SIZE	PLUG	TEE	90° BEND	45° BEND	22-1/2° BEND	11-1/4° BEND
4"	0.63	0.63	0.89	0.48	0.25	0.12
6"	1.40	1.40	2.00	1.08	0.55	0.28
8"	2.50	2.50	3.55	1.92	0.98	0.49
10"	3.93	3.93	5.55	3.00	1.53	0.77
12"	5.65	5.65	8.00	4.33	2.21	1.11
14"	7.70	7.70	10.88	5.89	3.00	1.51
16"	10.05	10.05	14.21	7.89	3.85	1.97
18"	12.70	12.70	17.99	9.74	4.96	2.49
20"	15.71	15.71	22.22	12.02	6.13	3.08
24"	22.67	22.67	32.00	17.31	8.83	4.43
27"	28.63	28.63	40.48	21.91	11.17	5.61
30"	35.35	35.35	50.00	27.06	13.79	6.93
36"	50.90	50.90	72.98	38.95	19.89	9.98
42"	69.27	69.27	97.97	53.02	27.03	13.58
48"	90.48	90.48	127.96	69.25	35.30	17.74
54"	114.51	114.51	161.94	87.64	44.68	22.45

NOTES ON THRUST BLOCKING

- ALL BLOCKING SHALL BE AGAINST UNDISTURBED HAND DUG SOIL AND SHALL BE CONCRETE HAVING A MINIMUM 28 DAY STRENGTH OF 2000 LBS PER SQUARE INCH.
- THRUST CALCULATIONS TO BE BASED ON THRUST DUE TO WATER PRESSURE AT 100% OF TEST PRESSURE. THRUST = 2 AP SIN 1/2 # WHERE A = AREA OF PIPE, P = WATER PRESSURE, # = DEFLECTION ANGLE.
- VERTICAL UPLIFT BLOCKS SHALL BE DESIGNED ON THE BASIS OF 150 LBS. PER CU. FT. FOR CONCRETE AND SOIL AT 120 LBS. PER CU. FT. OVER THE AREA OF BLOCK.
- VERTICAL DOWN THRUST BLOCKS SHALL BE DESIGNED ON THE BASIS OF 2000 LBS PER SQ. FT. ALLOWABLE SOIL BEARING PRESSURE. DIMENSIONS MAY BE DECREASED WITH APPROVAL OF THE ENGINEER IF MEASURED SOIL CONDITIONS PERMIT. IN POOR SOIL CONDITIONS, BLOCK DIMENSIONS SHALL BE INCREASED IN PROPORTION TO ALLOWABLE BEARING VALUE.
- THRUST BLOCKS ON HORIZONTAL BENDS, TEES, CROSSES, AND REDUCERS SHALL BE SIZED BASED ON 2000 LBS. PER SQ. FT. OF BLOCKING SURFACE AREA IN CONTACT WITH UNDISTURBED SOIL. BLOCK DIMENSIONS MAY BE DECREASED WITH APPROVAL OF THE ENGINEER IF MEASURED SOIL CONDITIONS PERMIT. IN POOR SOIL CONDITIONS, BLOCK DIMENSIONS SHALL BE INCREASED IN PROPORTION TO THE ALLOWABLE BEARING VALUE.
- ALL BLOCKING SHALL HAVE A MINIMUM SOIL COVER OF 1 FT.
- ADDITIONAL REINFORCING MAY BE REQUIRED FOR HORIZONTAL BLOCKING TO HANDLE UNUSUAL SHEAR LOADING CONDITIONS.

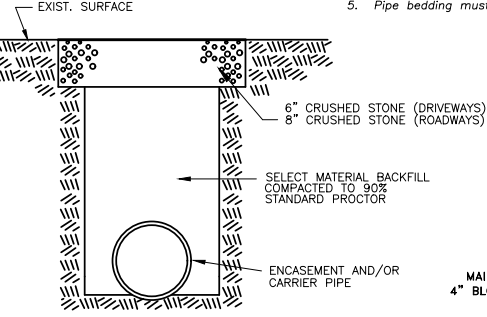

OPEN-CUT REPAIR DETAIL
GRAVEL SURFACE (NOT A PAY ITEM)



TYPICAL RR CROSSING
N.T.S.

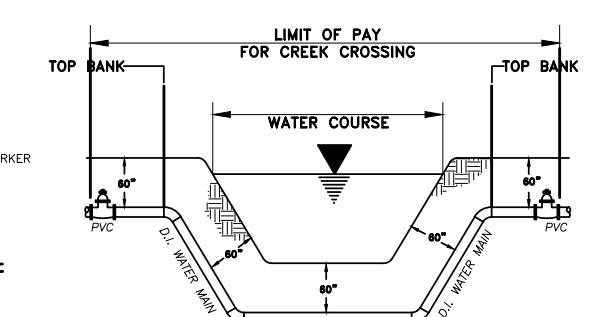

TYPE 1 CREEK CROSSING
N.T.S.

NOTE: INSTALL DUCTILE IRON MAIN FROM TOP BANK TO TOP BANK WITH MECHANICAL JOINT FITTINGS. DUCTILE IRON TO BE CONCRETE ENCASED PER CONCRETE ENCASEMENT DETAIL. WHEN CROSSING A WATER COURSE THAT IS GREATER THAN 15 FEET CONTRACTOR TO INSTALL ISOLATION VALVES ON EACH SIDE OF THE WATER COURSE.

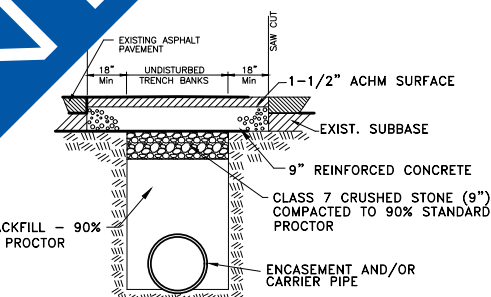

OPEN-CUT REPAIR DETAIL
STATE HIGHWAYS

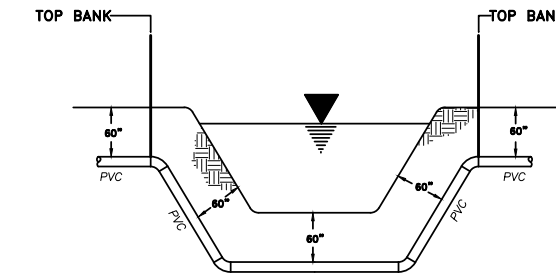

TYPE 3 CREEK CROSSING
N.T.S.

NOTE: INSTALL MAIN FROM TOP BANK TO TOP BANK WITH MECHANICAL JOINT FITTINGS AS NEEDED

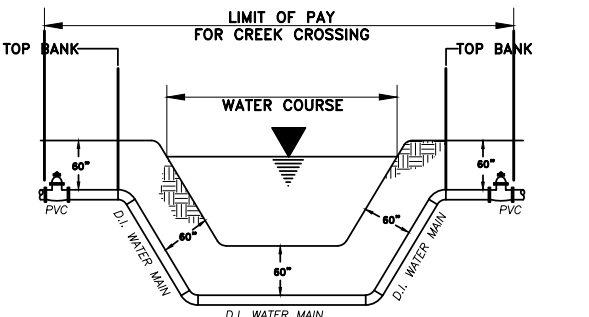

TYPE 2 CREEK CROSSING
N.T.S.

NOTE: INSTALL DUCTILE IRON MAIN FROM TOP BANK TO TOP BANK WITH MECHANICAL JOINT FITTINGS. WHEN CROSSING A WATER COURSE THAT IS GREATER THAN 15 FEET CONTRACTOR TO INSTALL ISOLATION VALVES ON EACH SIDE OF THE WATER COURSE.

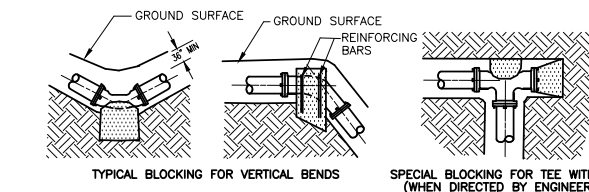

SPECIAL BLOCKING FOR TEE WITH PLUG
(WHEN DIRECTED BY ENGINEER)

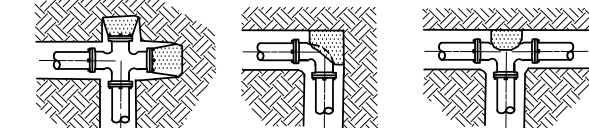

TYPICAL BLOCKING FOR HORIZONTAL BENDS

BLOCKING FOR TEE

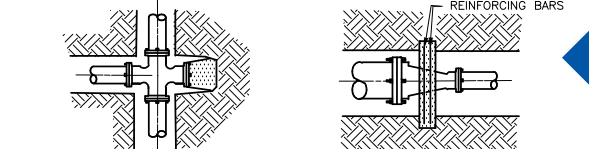

THRUST BLOCKING DETAILS
N.T.S.

4" BLOW-OFF ASSEMBLY
N.T.S.

NON-FREEZING, SELF DRAINING TYPE WITH A 3" MIN. BURY. BE FURNISHED WITH A 4" LEAD VALVE AND 4" INLET, A OPERATING ROD AND SHALL OPEN TO THE LEFT. THE OPERATING MECHANISM SHALL BE OF BRONZE-BRONZE DESIGN WITH AN ALUMINUM HANDLE AND BE SERVICEABLE FROM ABOVE GRADE WITH NO DIGGING. THE OUTLET SHALL BE 4" FIP WITH PLUG AND EXTEND A MIN. 12" ABOVE GROUND. MODEL# JARD #7500, AS MANUFACTURED BY KUPFERLE FOUNDRY, CO. OR APPROVED EQUIVALENT.

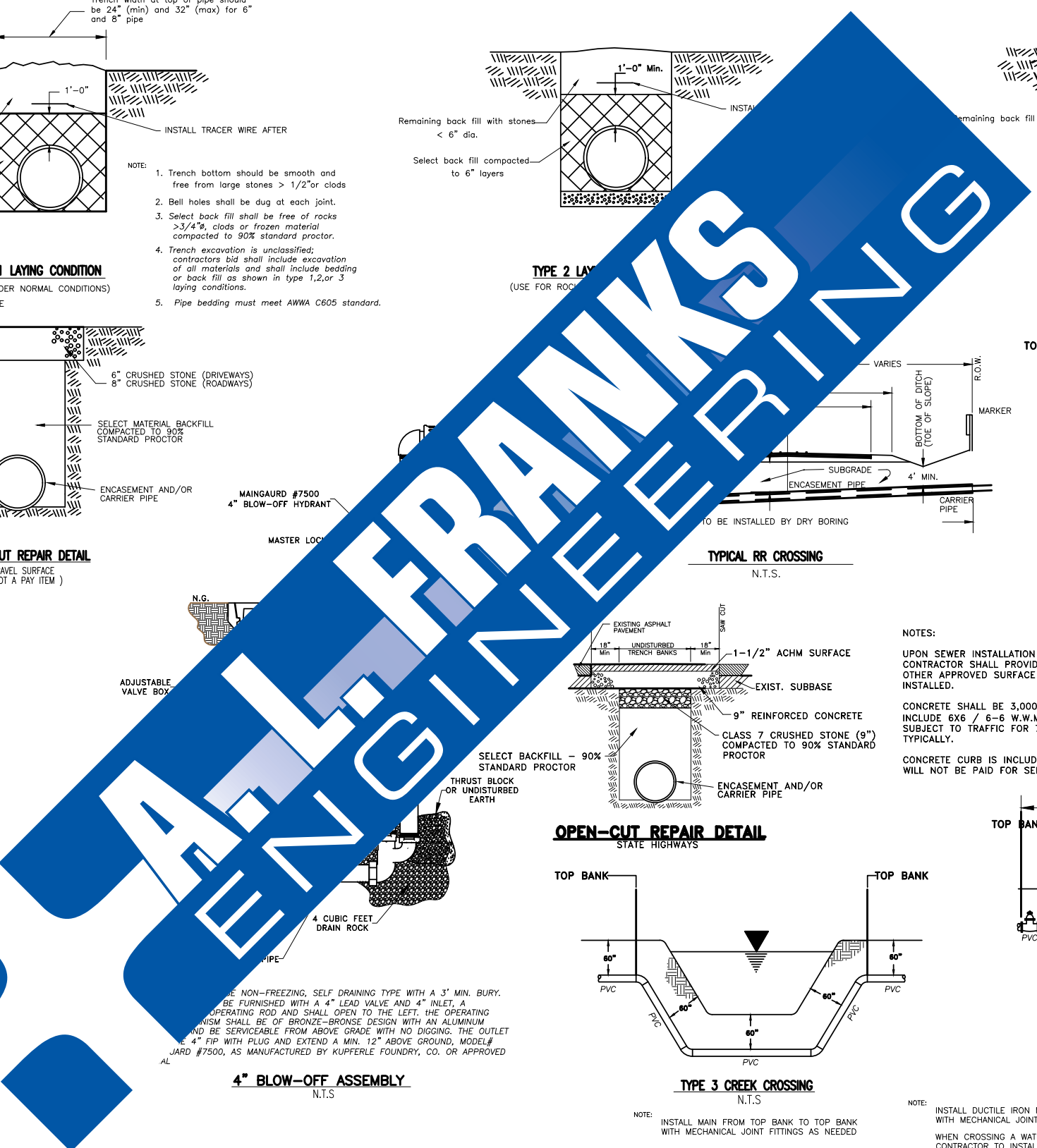

No.	Date	Revision	By
A	3/18/26	REVISED AS MARKED	LWH



118 East Broad Street
Texarkana, Arkansas 71854
Phone (870) 216-1906
Fax (870) 216-1907

101 West Main, Ste. 413
El Dorado, Arkansas 71730
Phone (870) 444-5160
Fax (870) 444-5161

CONSTRUCTION DETAILS
CITY OF MCGEE, ARKANSAS
WATERLINE IMPROVEMENTS

Job No.: MCG-03-26
Scale: N.T.S.
Date: JAN. 2026
Sheet 14

